

HEXBUG®

VEX®  
ROBOTICS

赫宝VEX古典系列

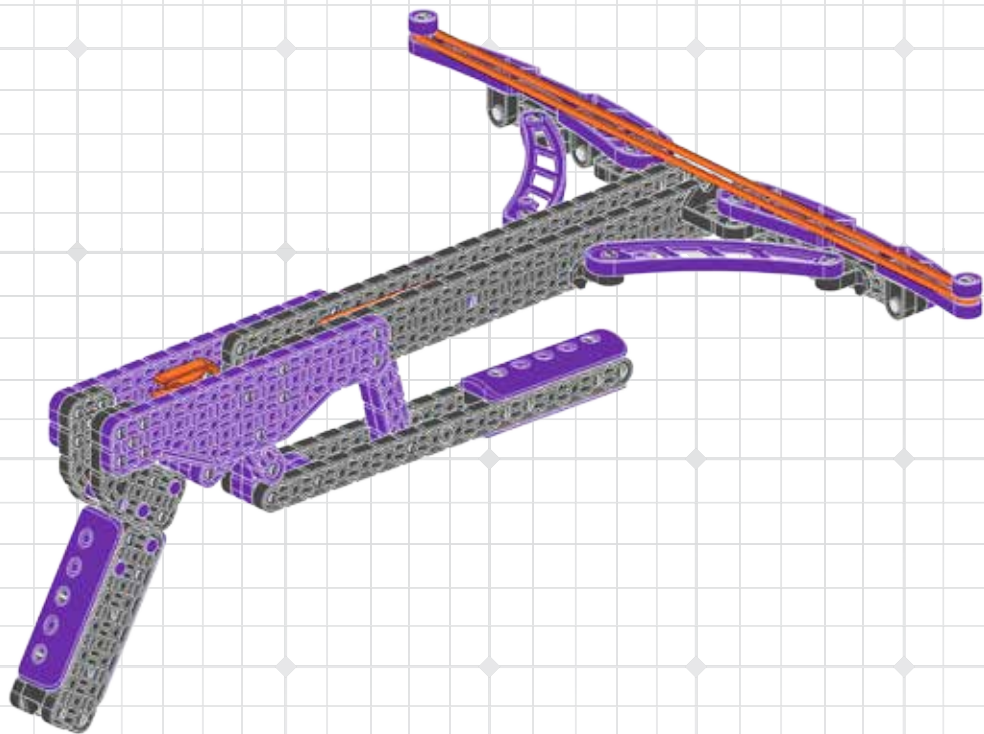

飞机弩

组装前请核对零件型号及规格

1:1

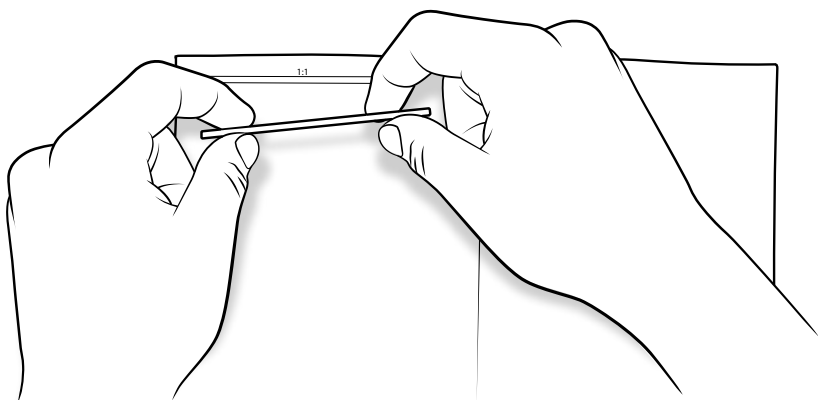
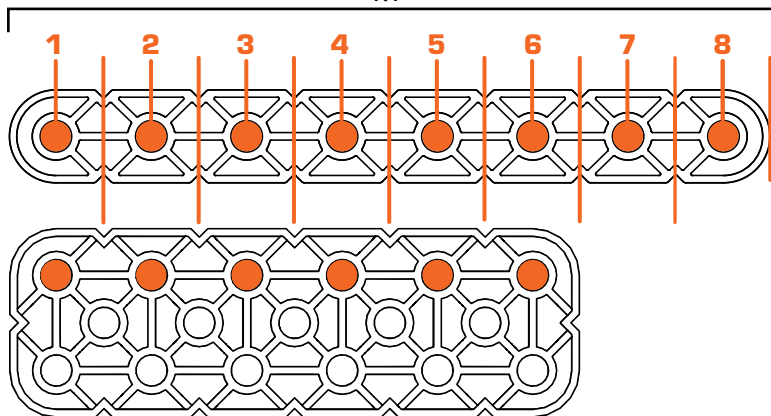

检查零件的实际尺寸  
并与说明书上的尺寸比对



警告



正确



翻转



错误



注意



多视角查看

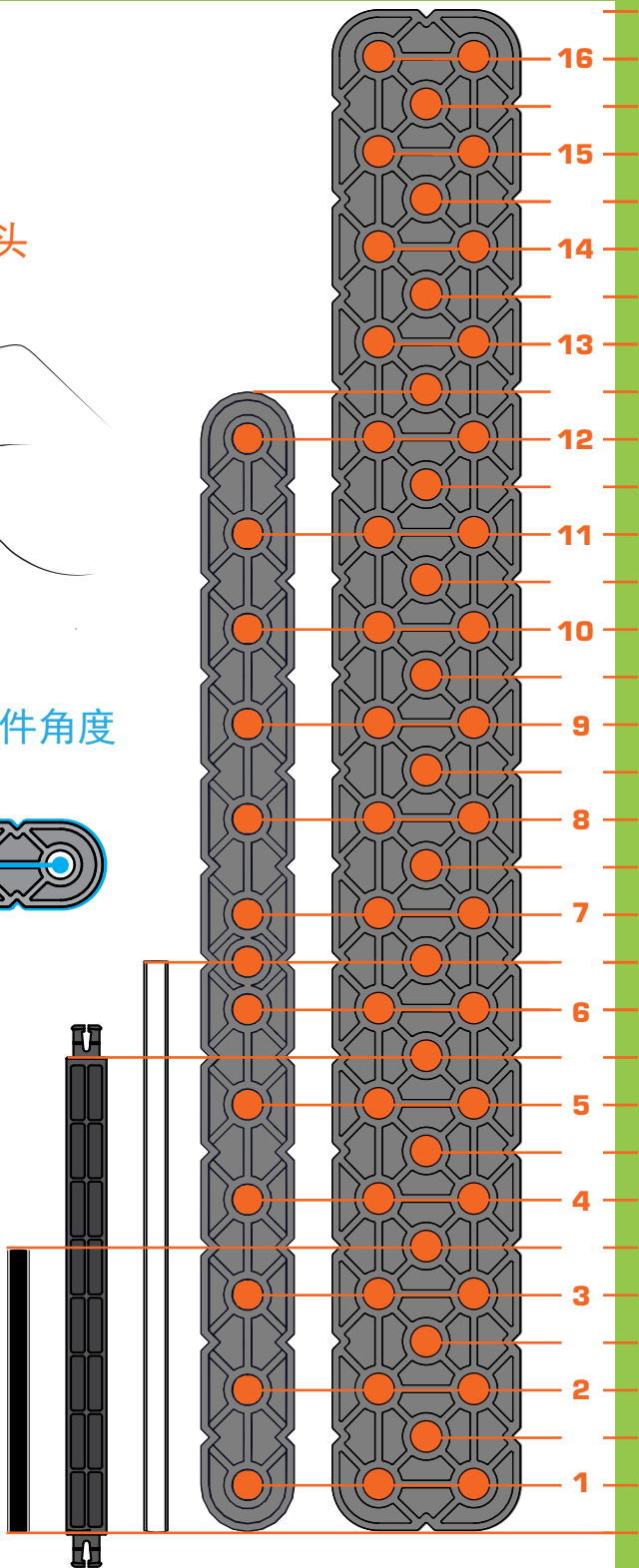
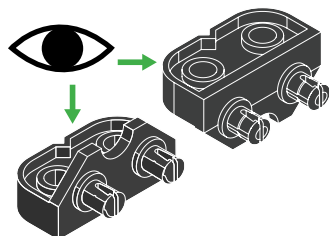
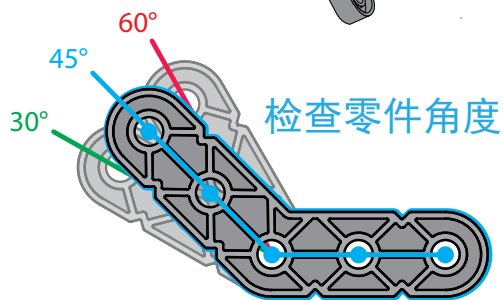
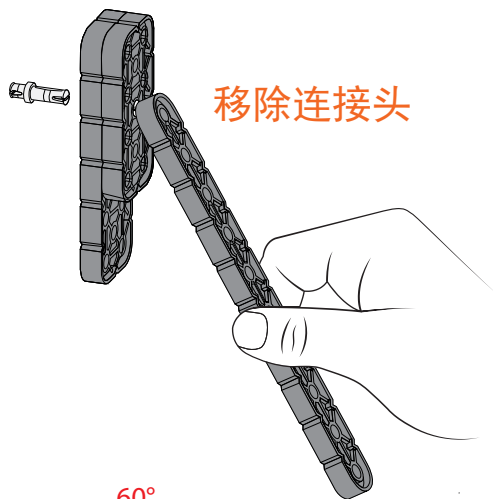

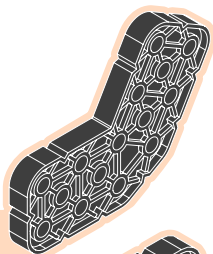

2x3x3 60°

2x

228-3201-1268

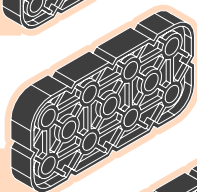

2x4

2x

228-3201-019

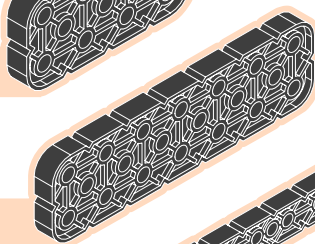

2x7

1x16

2x

228-3201-022

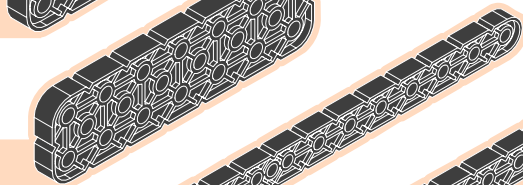

1x20

2x

228-3201-014

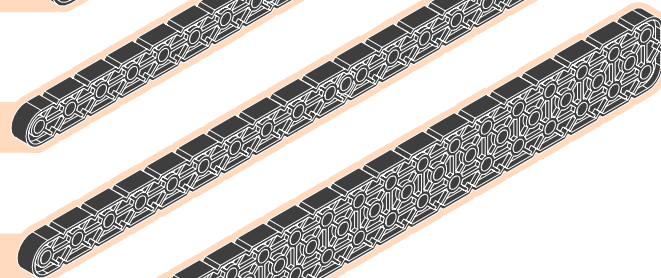

2x20

1x

228-3201-016

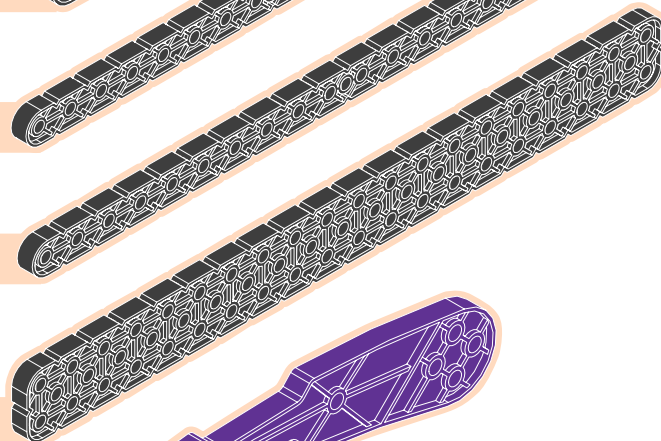

2x

228-3201-030

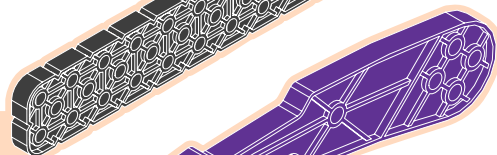

2x

228-4152-472



2x

228-4152-293

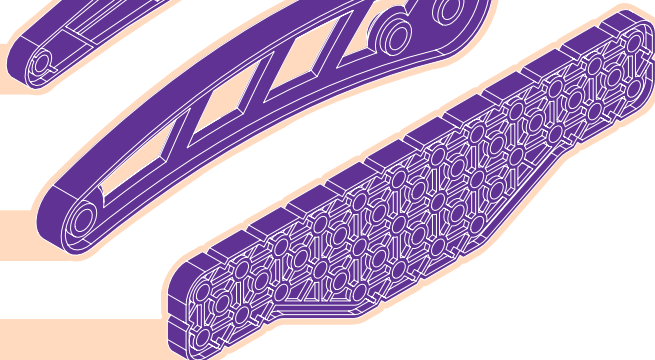

2x

228-4152-1600



**2x** 228-4152-002

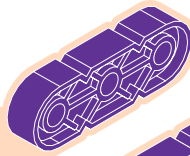

1x3

1x5

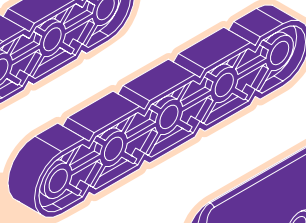

**4x** 228-4152-004

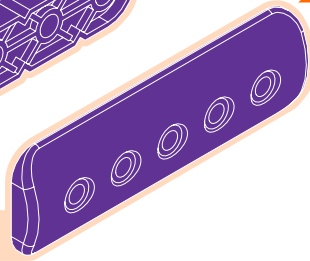

**4x** 228-4152-1436

**2x** 228-4152-154



**2x** 228-4152-145

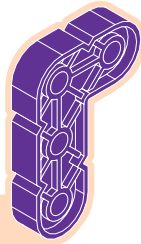

**2x** 228-4152-146



**2x** 228-3446-157

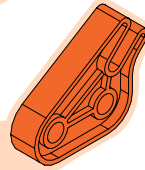

**3x** 228-3446-001

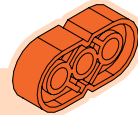

1x2

# 零件清单



9x

228-3448-086



0x2

4x

228-3943-087

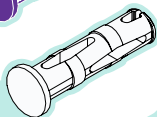

0x3

38x

228-3943-060

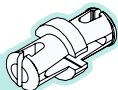

1x1

2x

228-3201-064

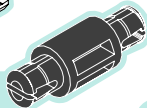

0.5x

11x

228-3943-062

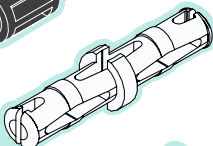

2x2

4x

228-3201-061

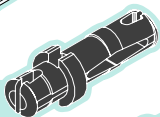

1x2

7x

228-3448-065

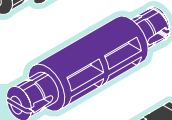

1x

2x

228-3201-136

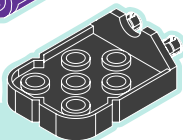

1x

228-3201-270

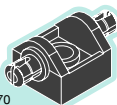

4x

228-3201-133

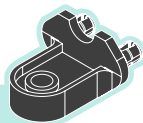

3x

228-3201-271

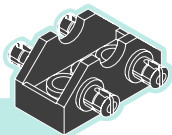

4x

228-3201-130

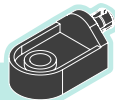

2x

228-3201-272

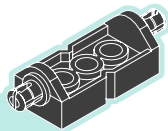

4x

228-3201-109



**2x**  
228-3446-475

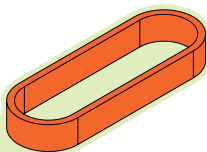

**1x**  
228-3446-470

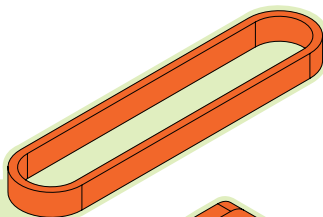

**3x**  
228-3446-1700

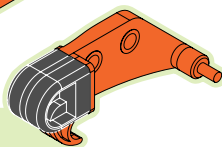

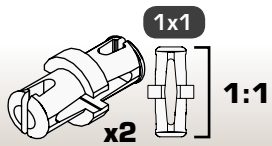
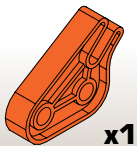
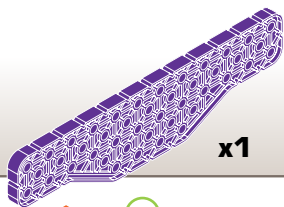

1

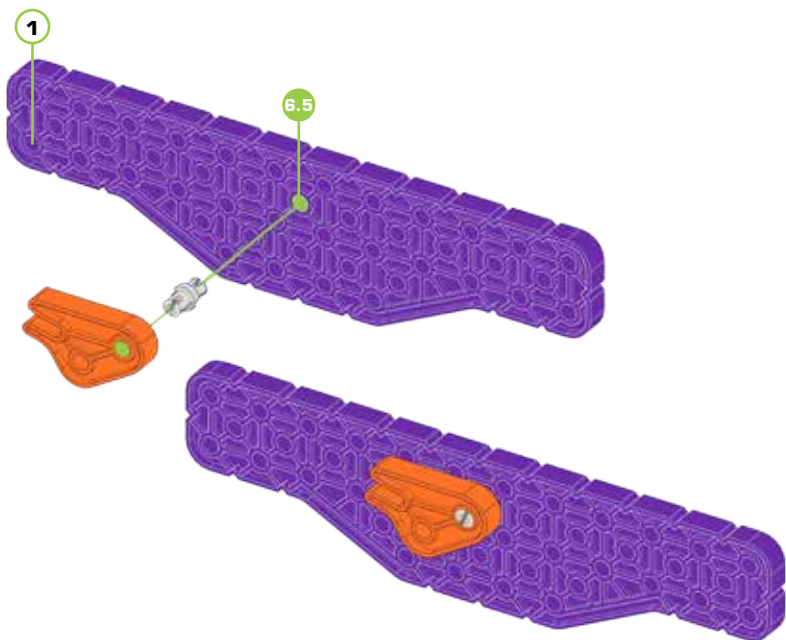

2

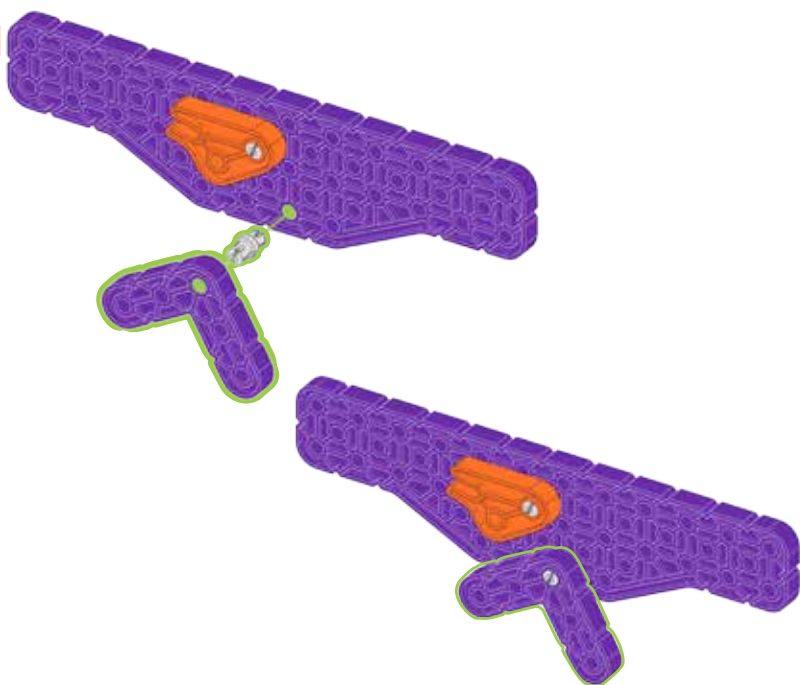



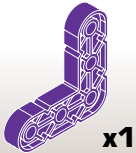

x1

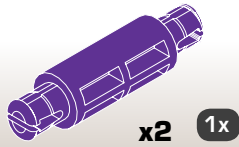

x2

1x



1:1

3

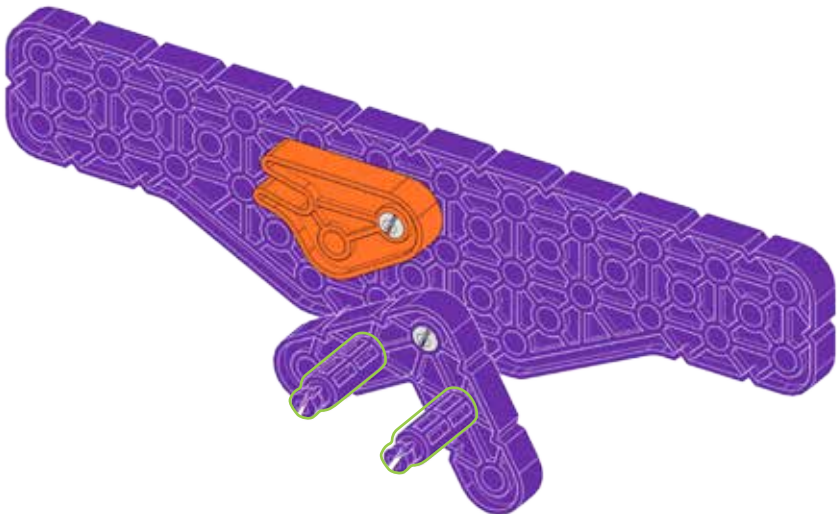
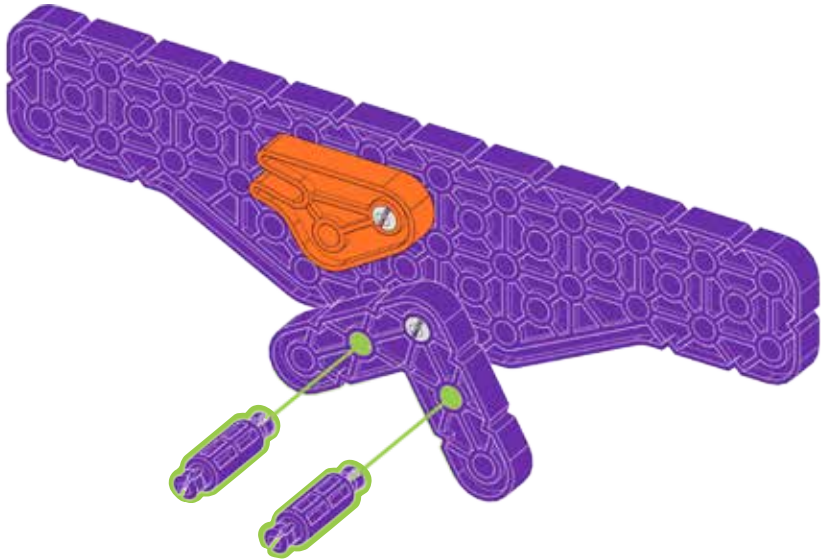

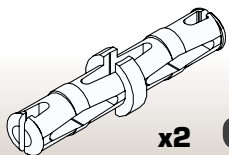
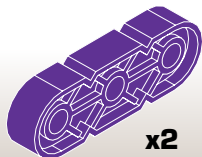

2x2

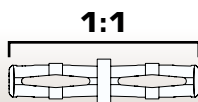

4

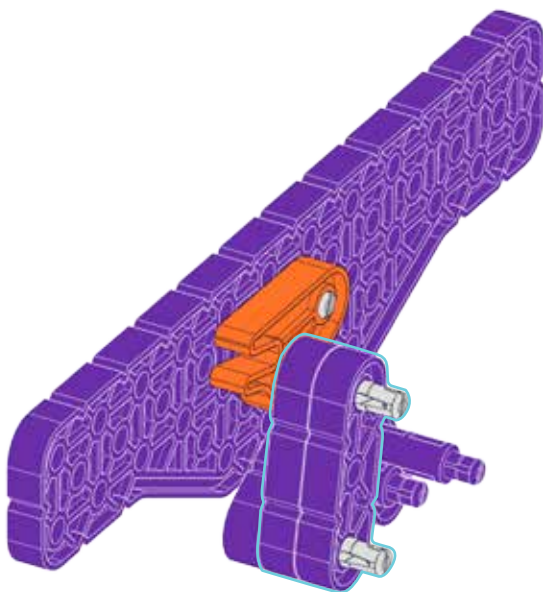
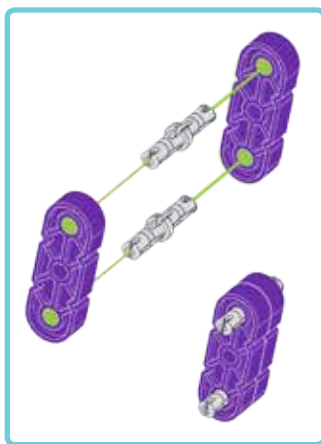
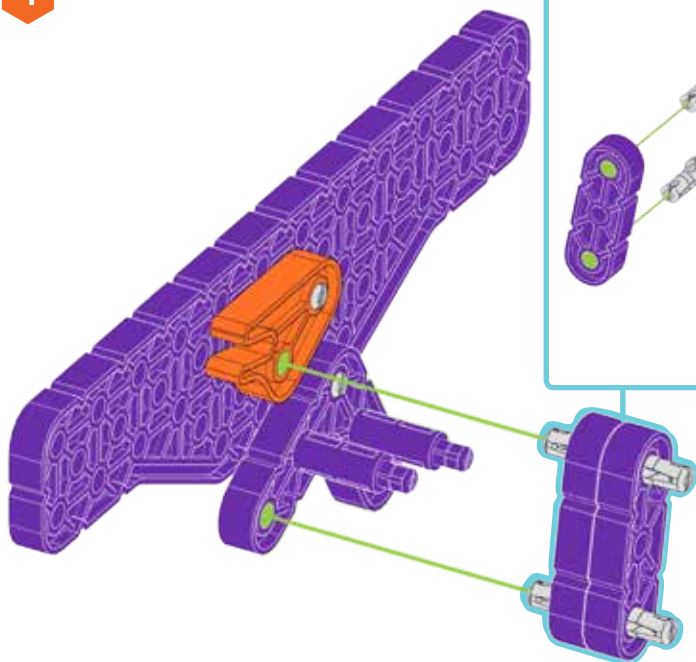

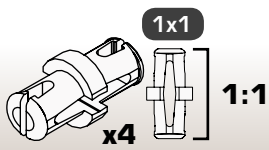

5

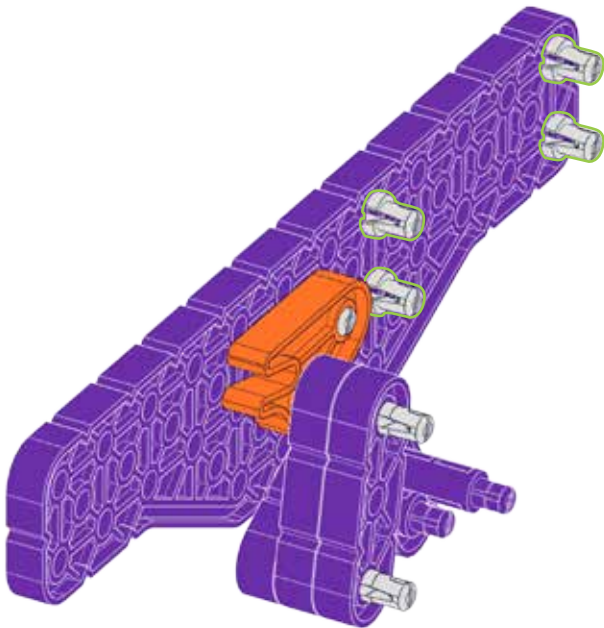
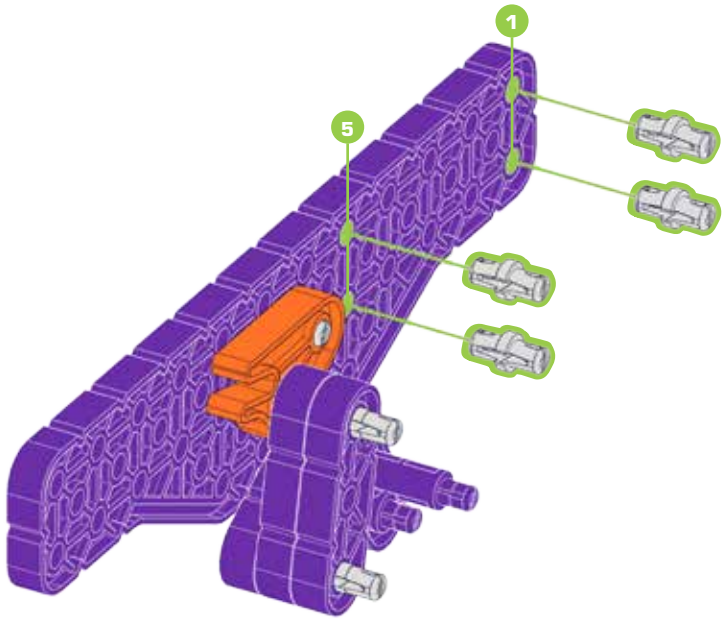

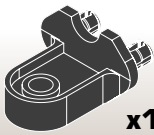

x1

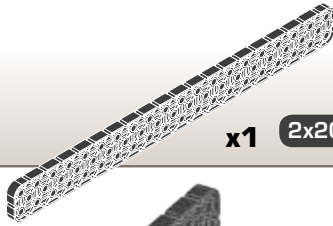

x1

2x20



x2

6

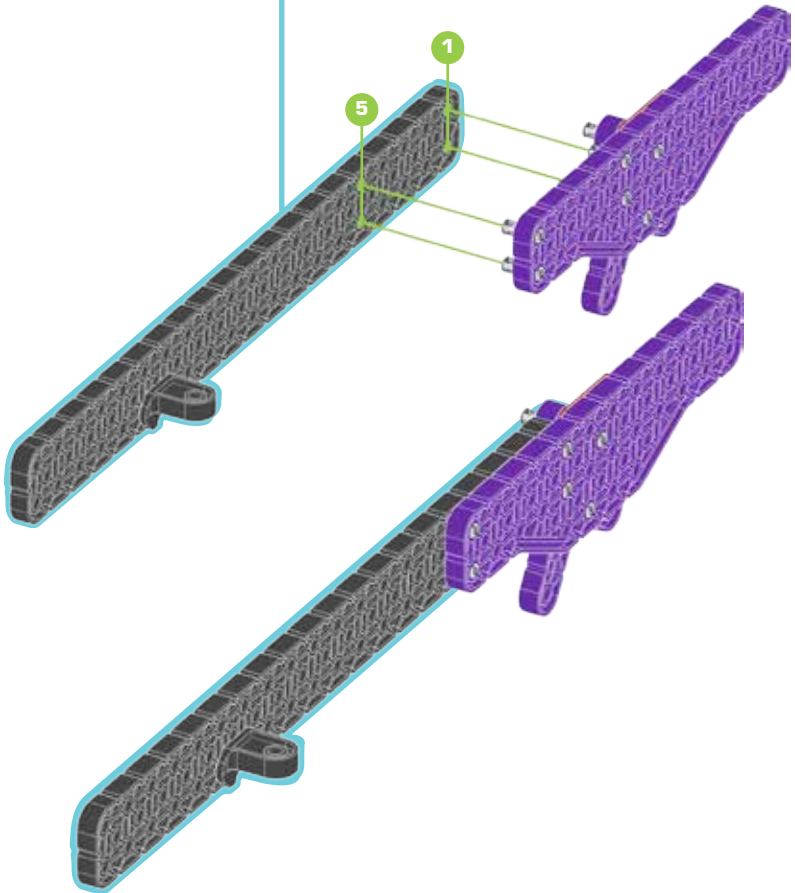
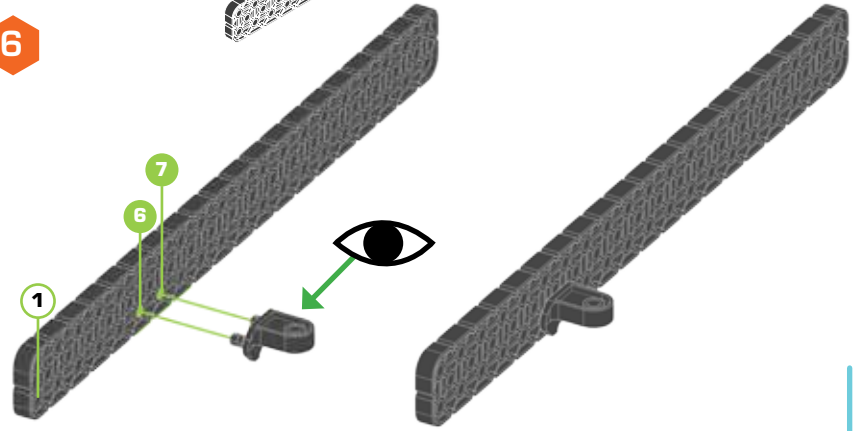

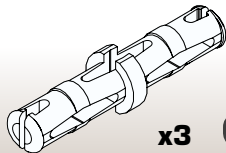

x3

2x2

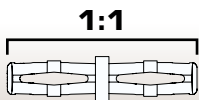

1:1

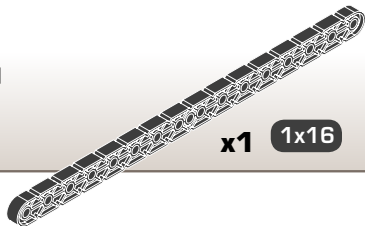

x1

1x16

7

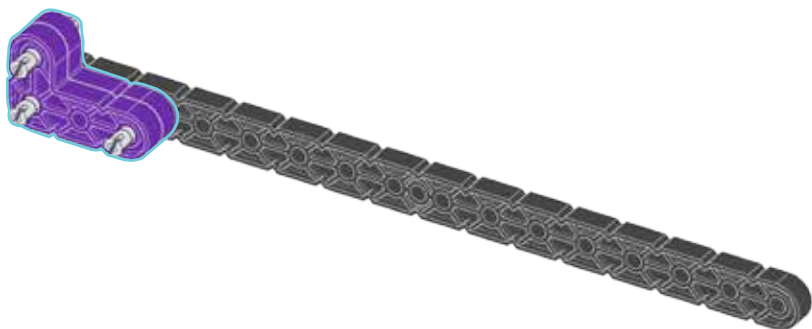
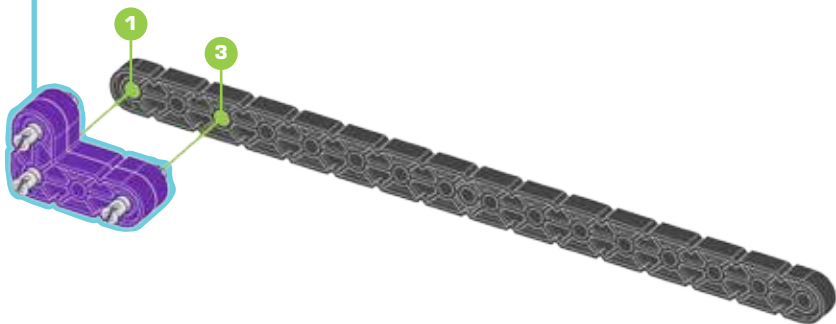
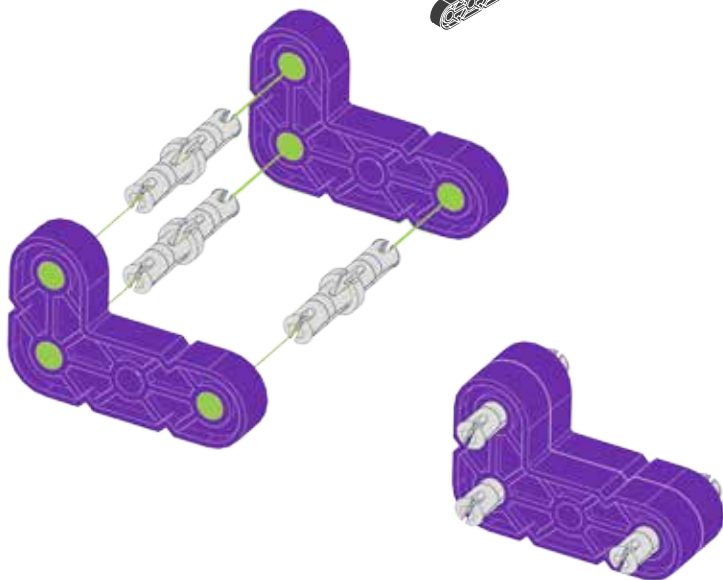

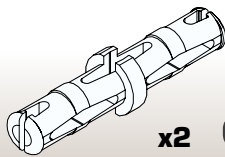
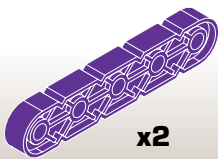

2x2

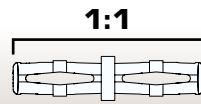

8

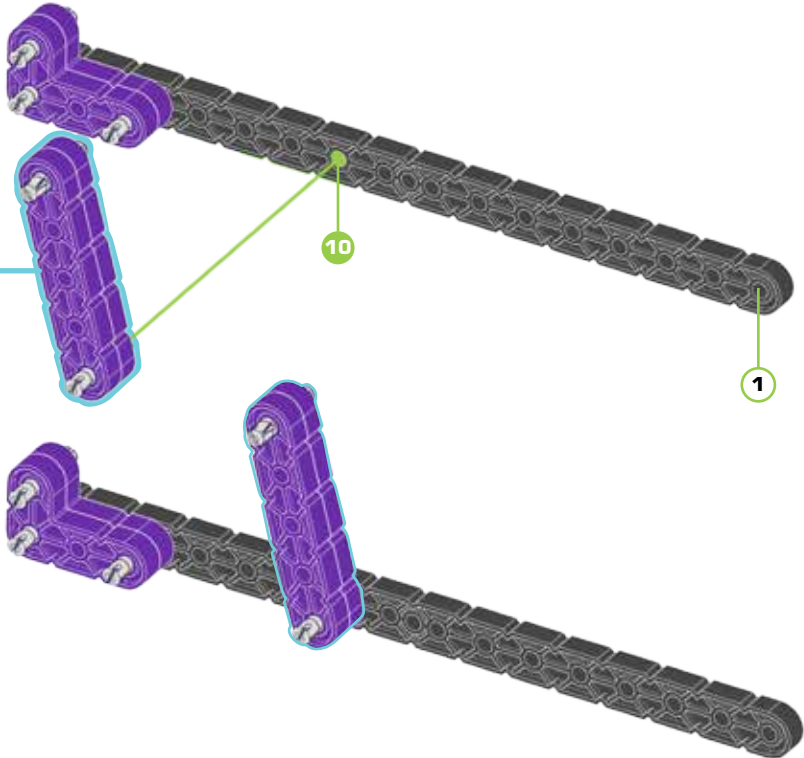
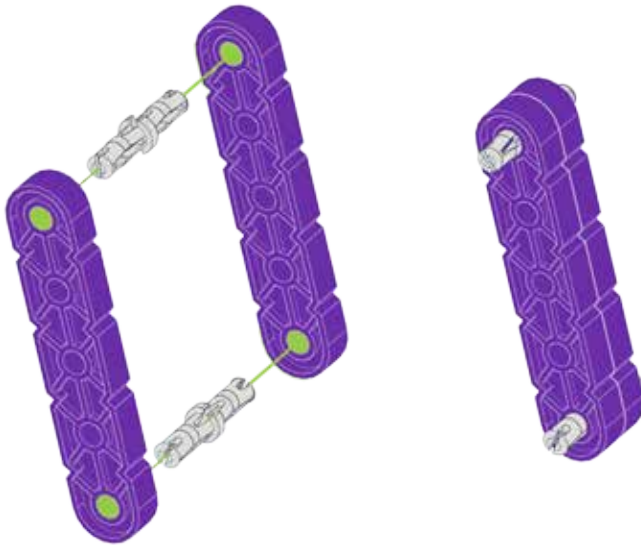

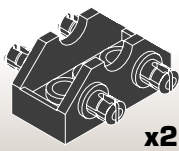
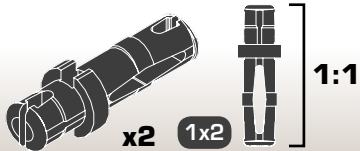

9

2X

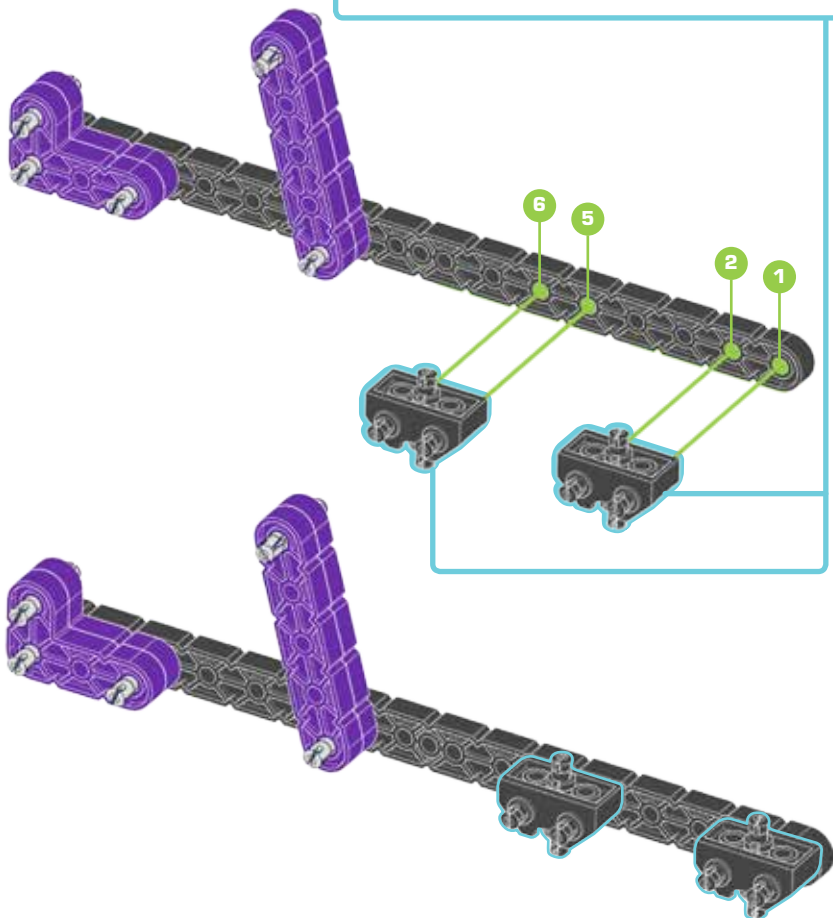
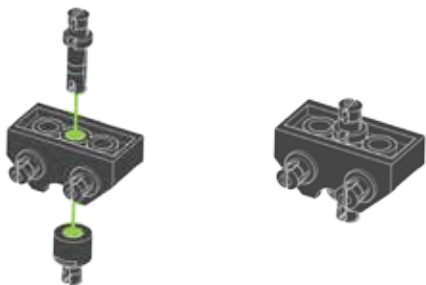

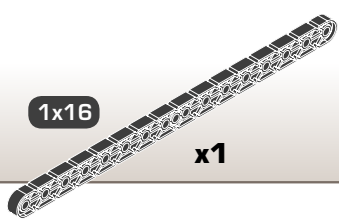

1x16

x1

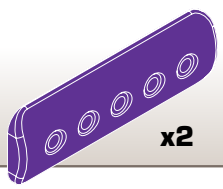

x2

10

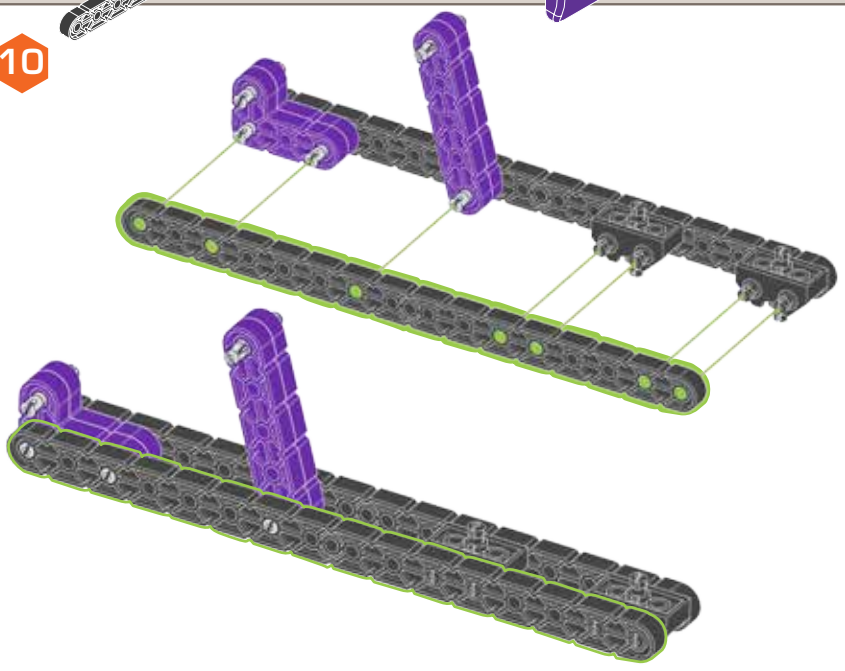

11

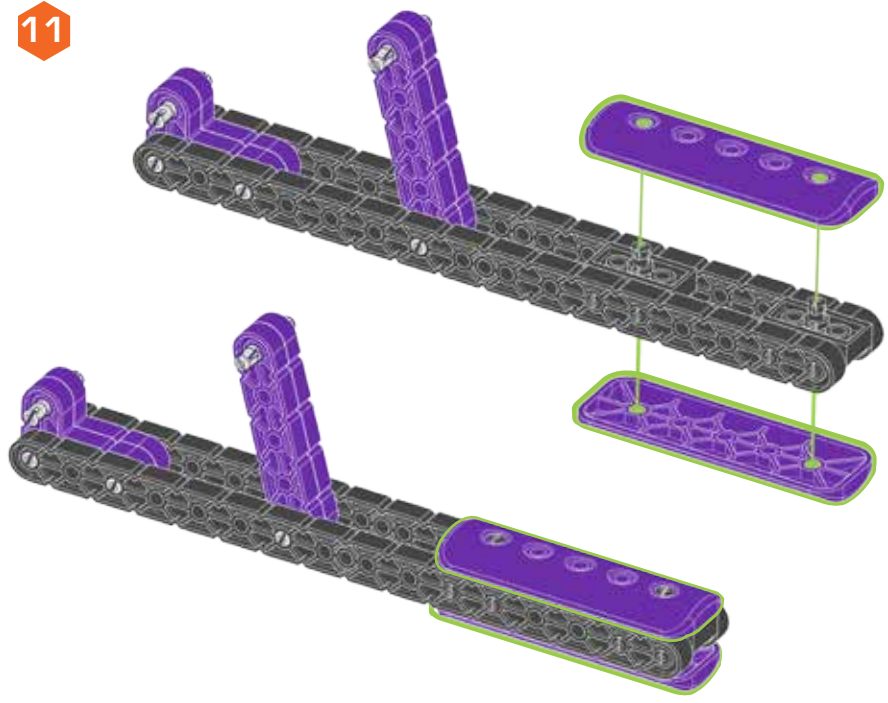



12

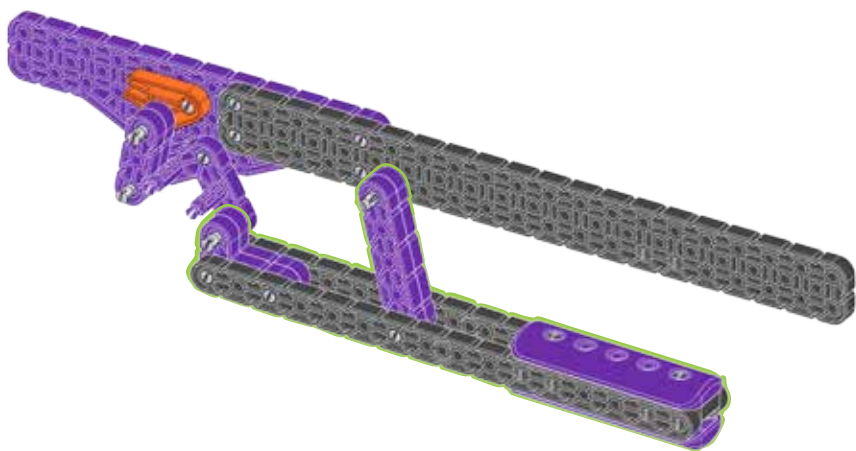
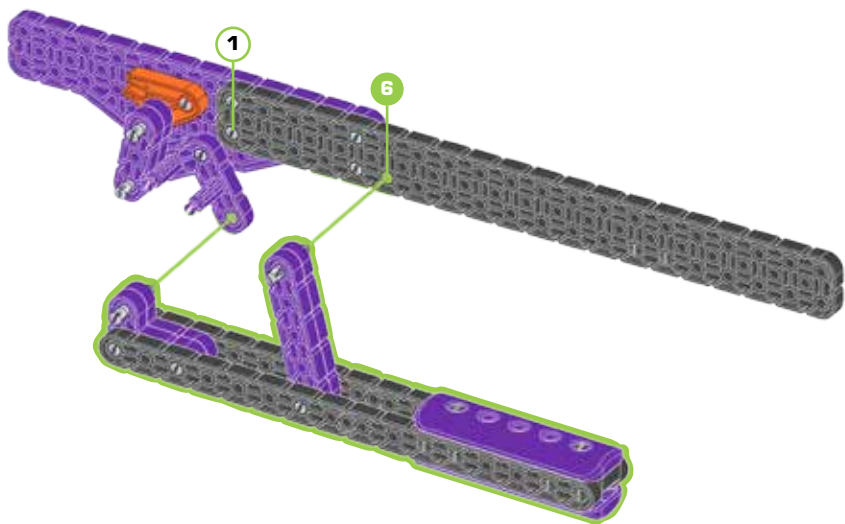

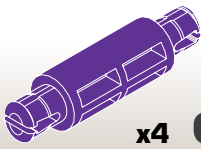

x4

1x



1:1

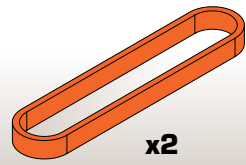

x2

13

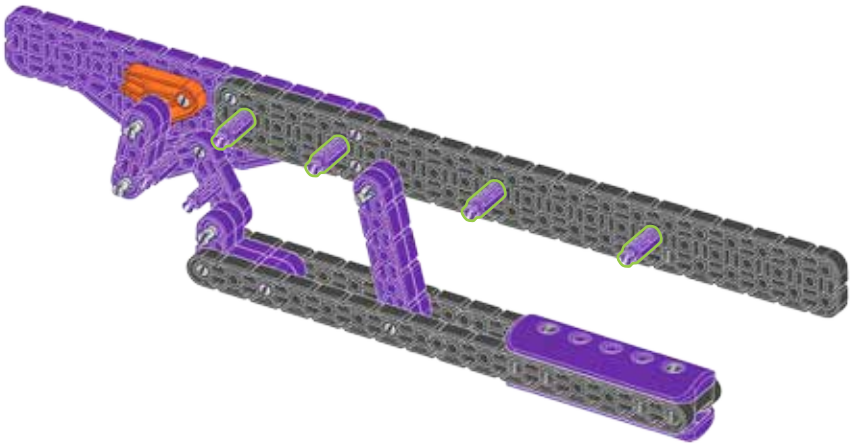
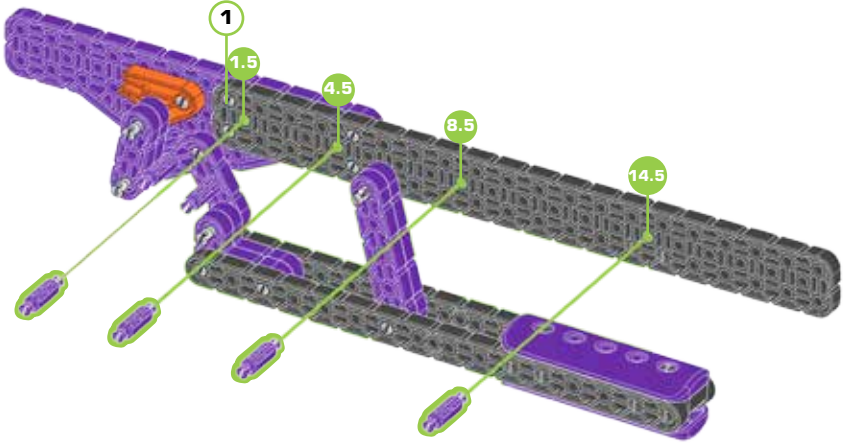

14

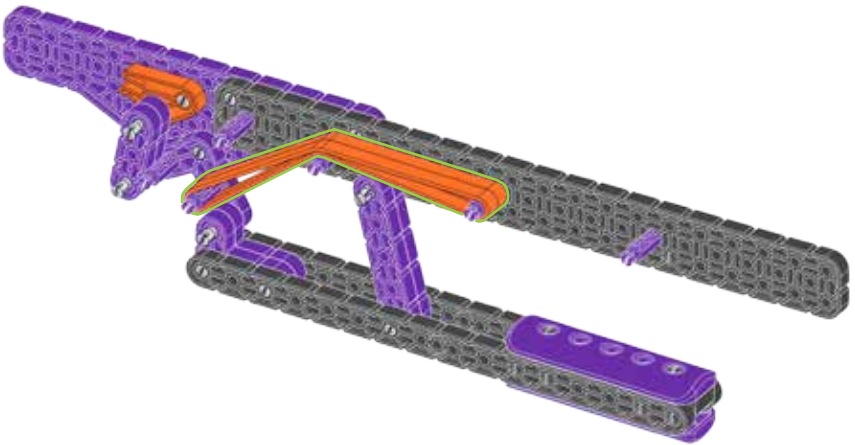
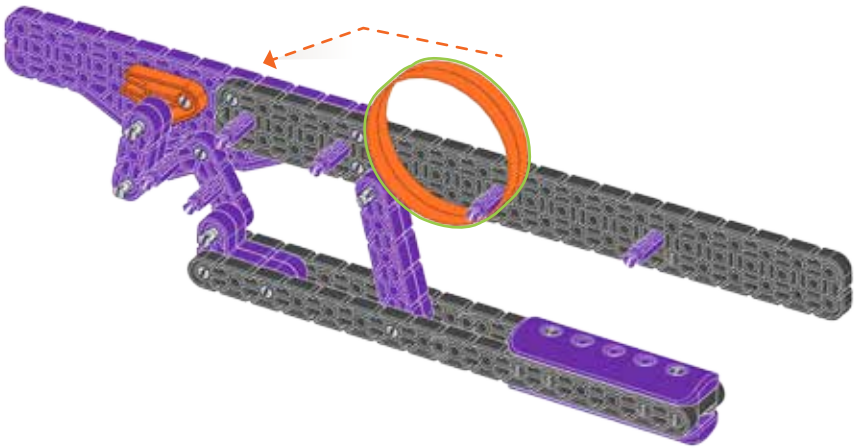

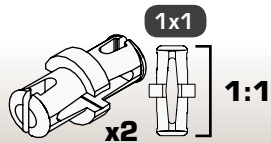
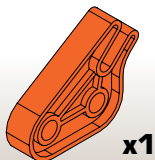
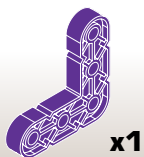

15

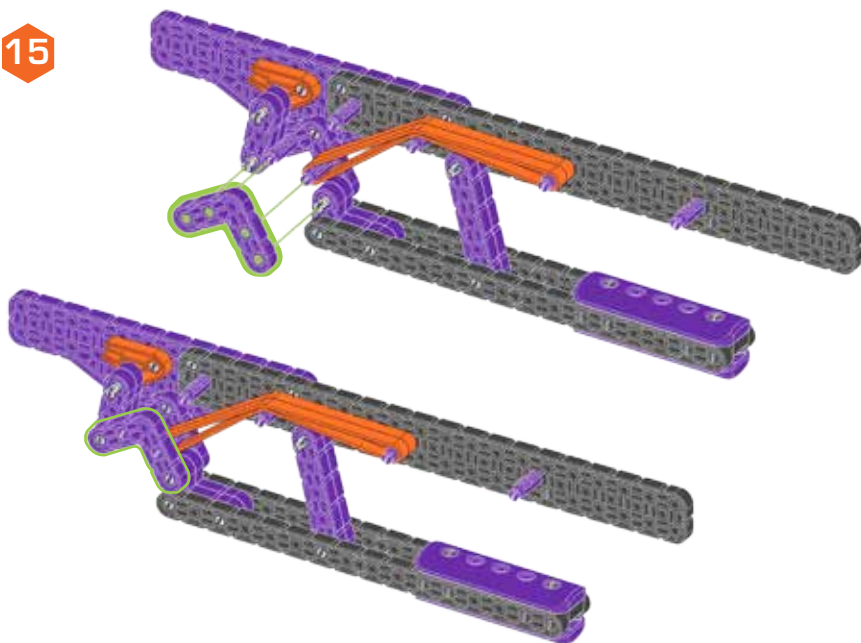

16

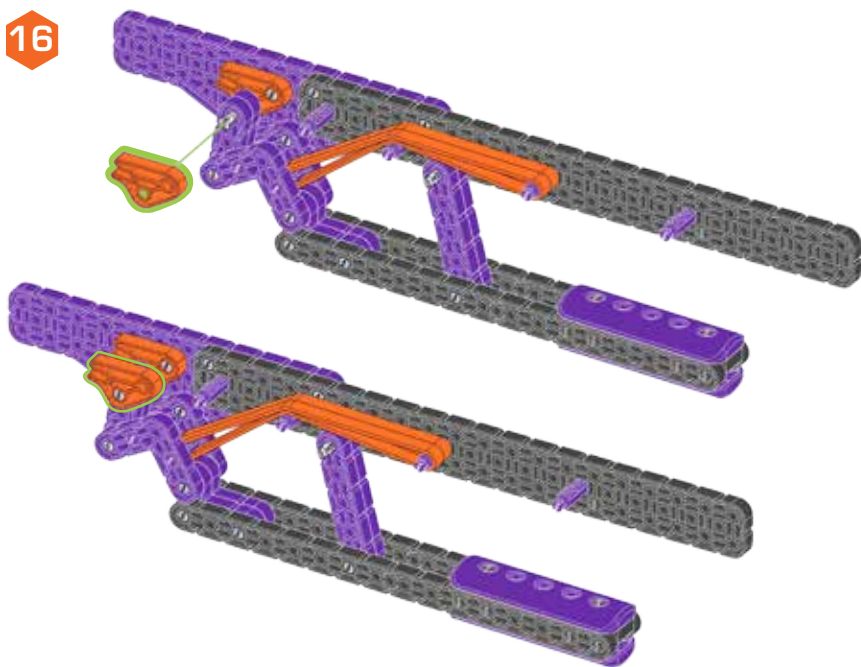

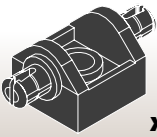

x1

17

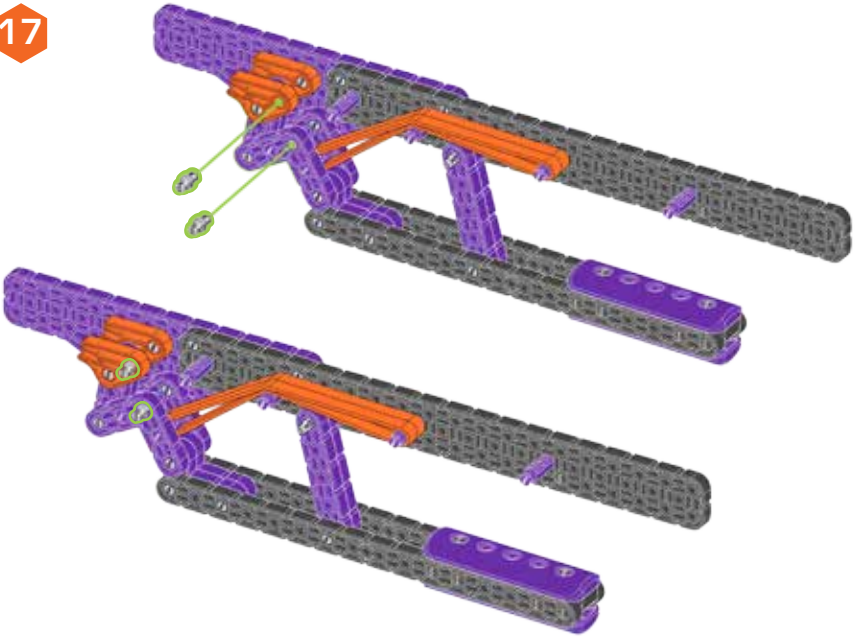

18

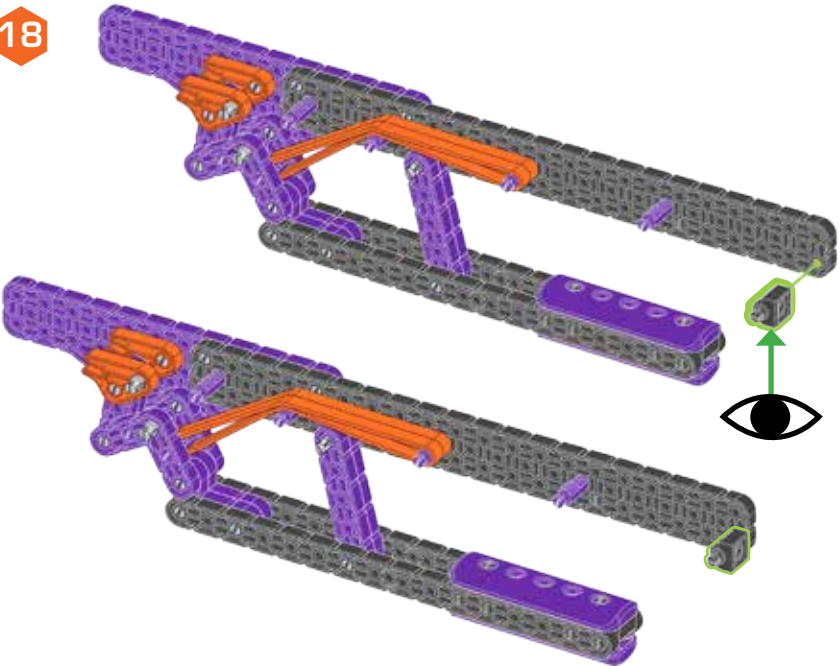

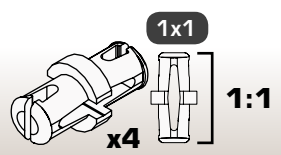
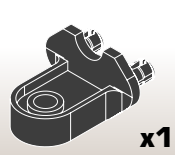
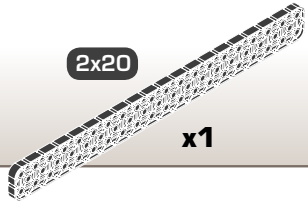

19

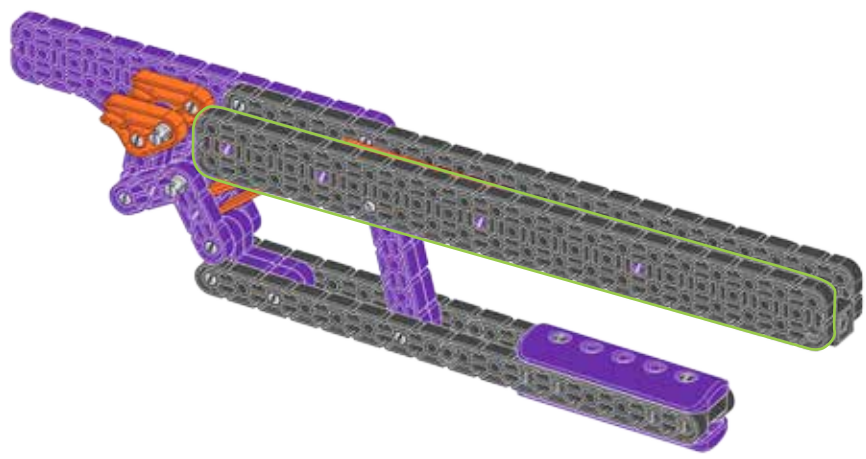
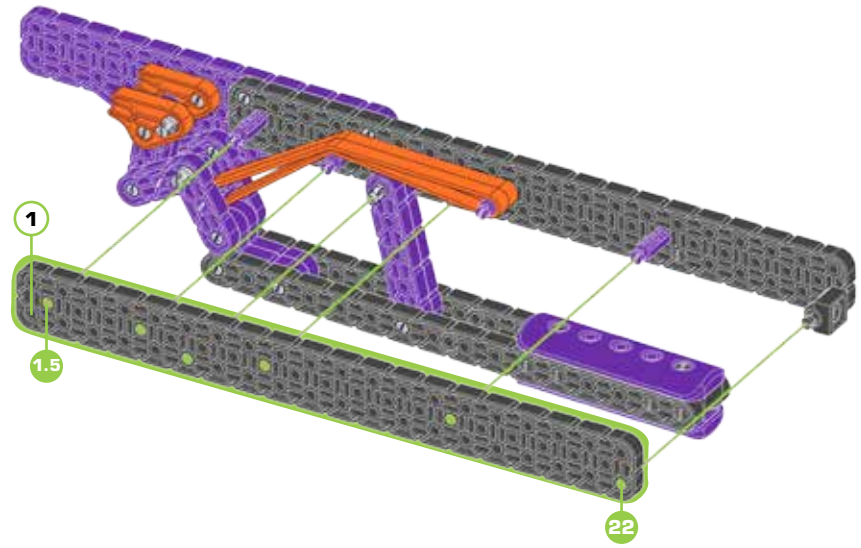

20

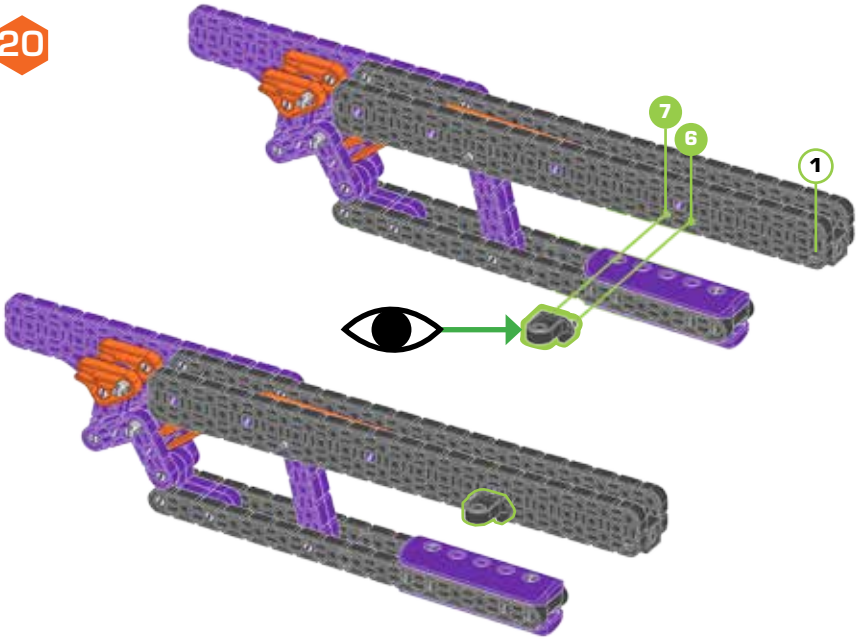

21

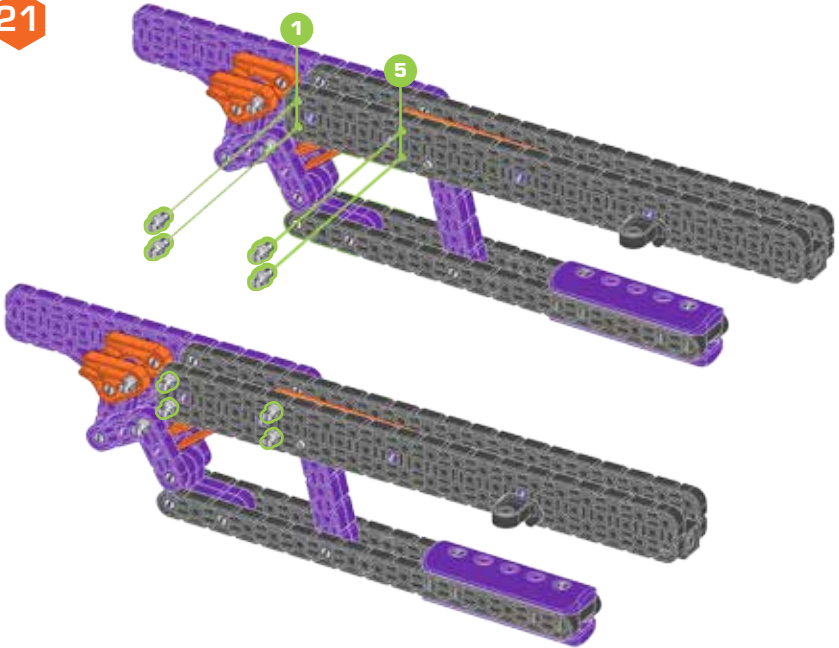

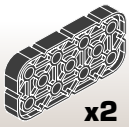

x2

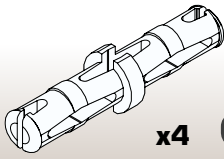

x4

2x2

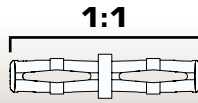

1:1

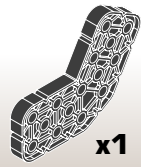

x1

22

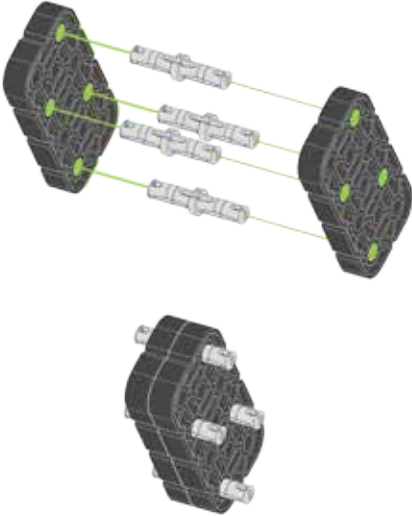

23

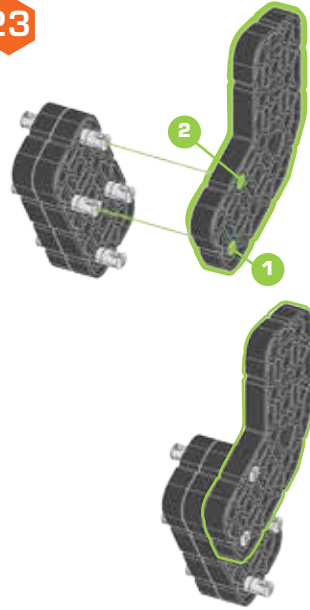

24

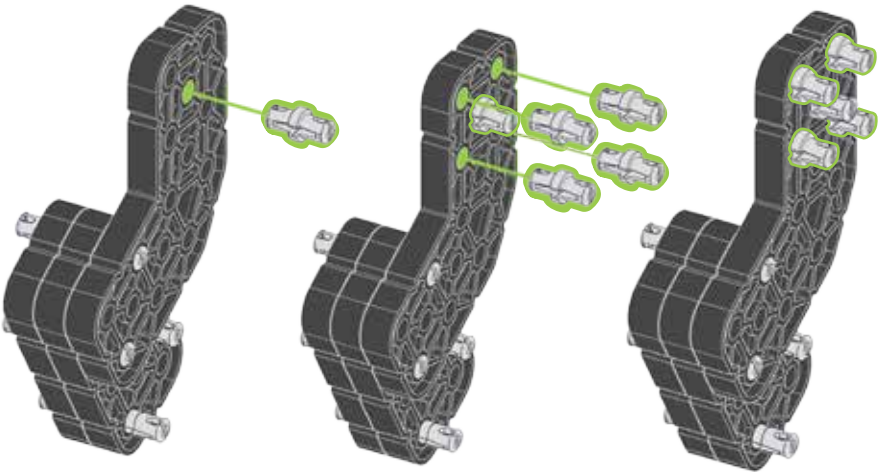



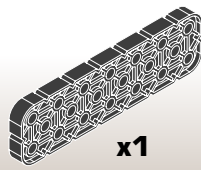
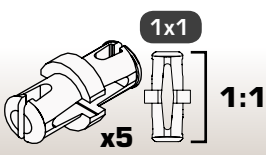

25

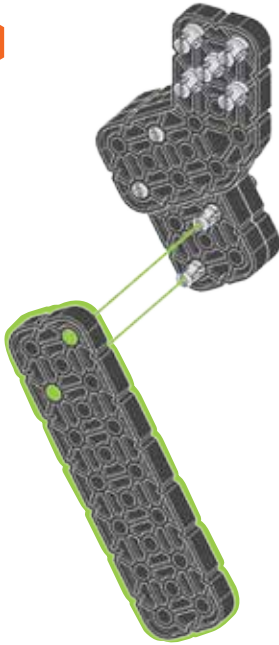

26

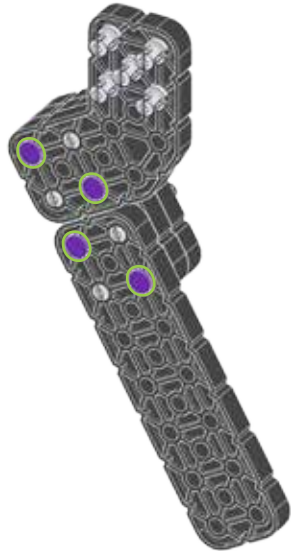
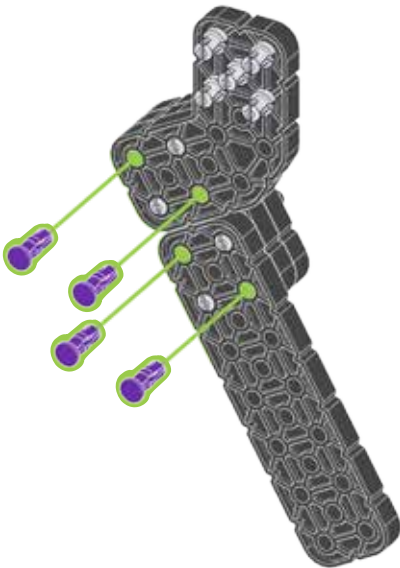

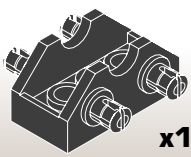

x1

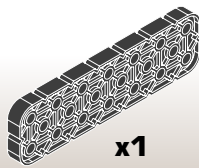

x1

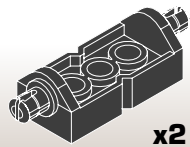

x2

27

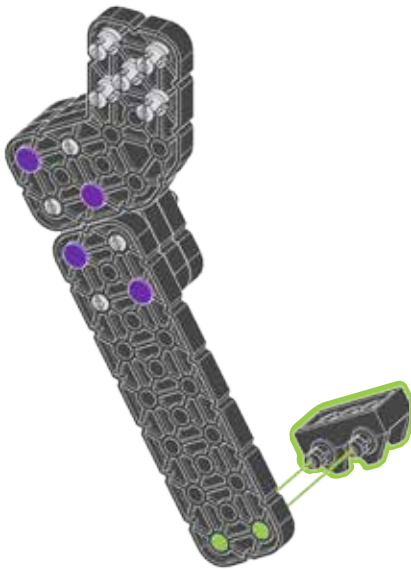

28

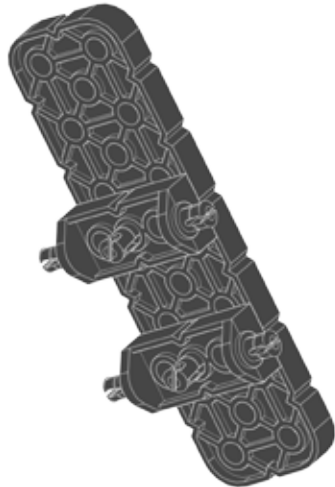
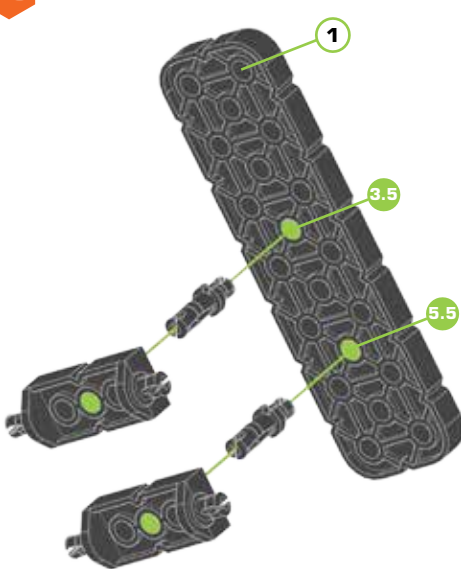

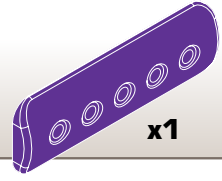
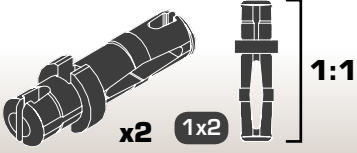

29

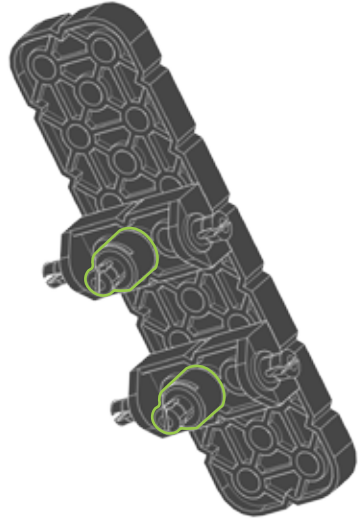
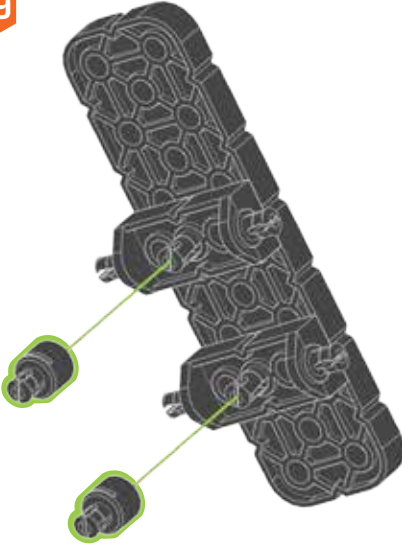

30

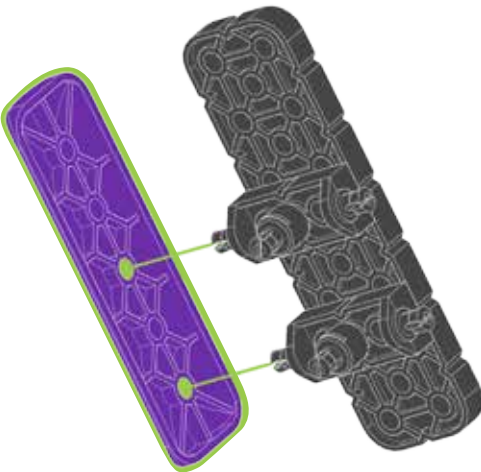

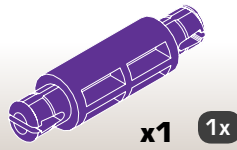
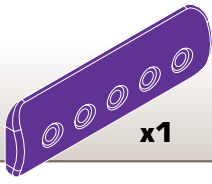

31

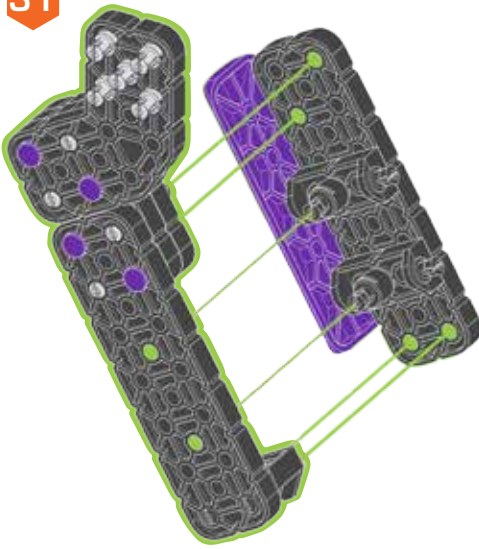

32

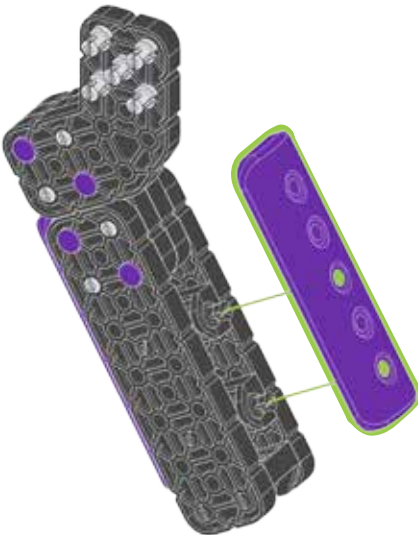

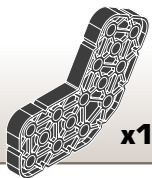

x1

33

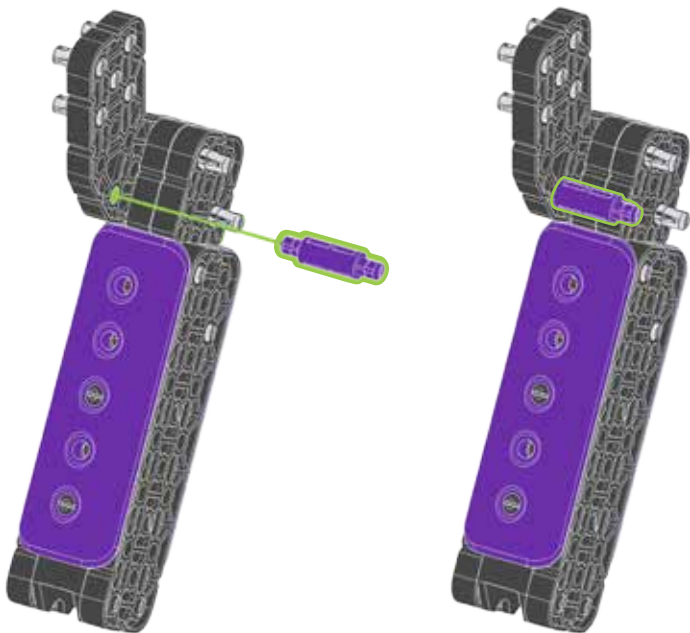

34

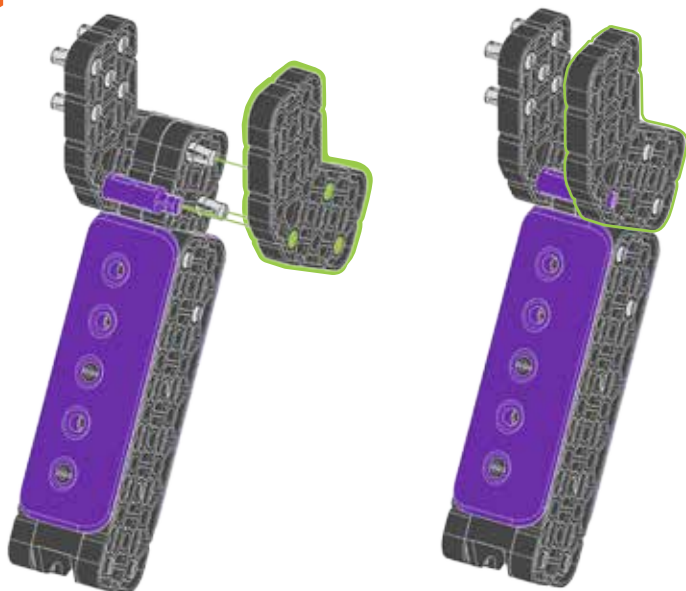

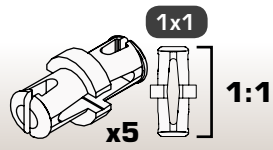

35

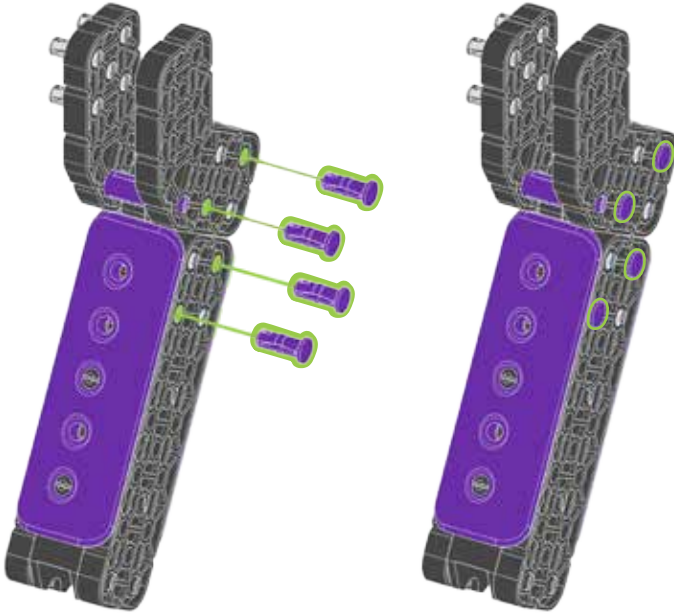

36

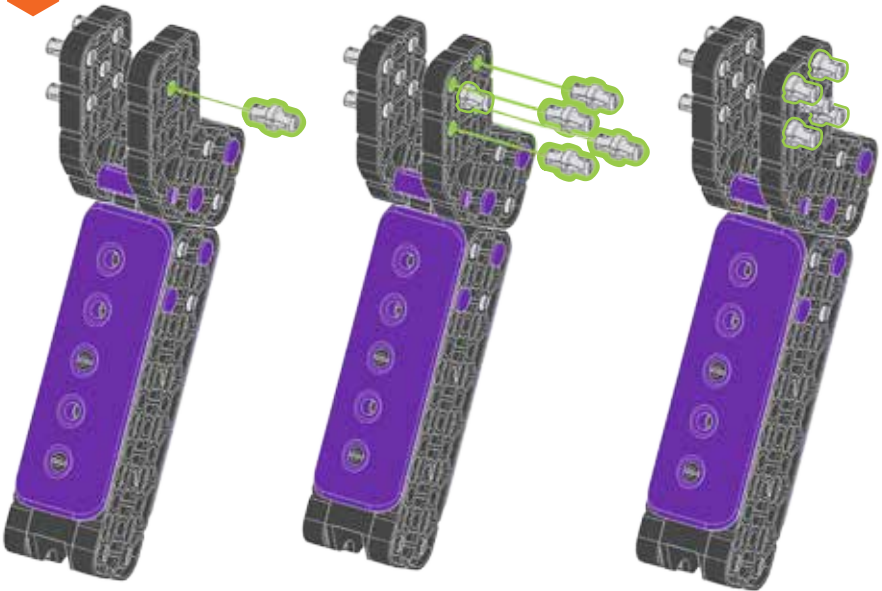

37

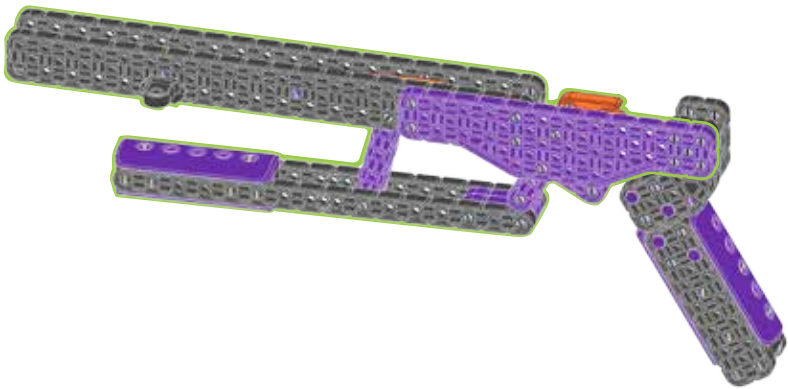
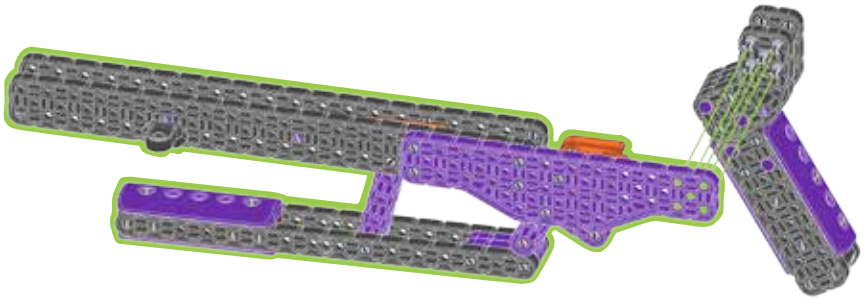

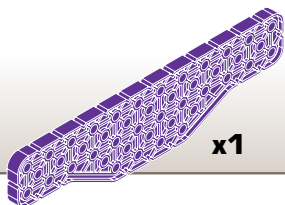

x1

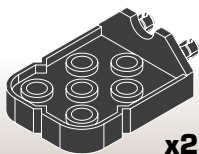

x2

38

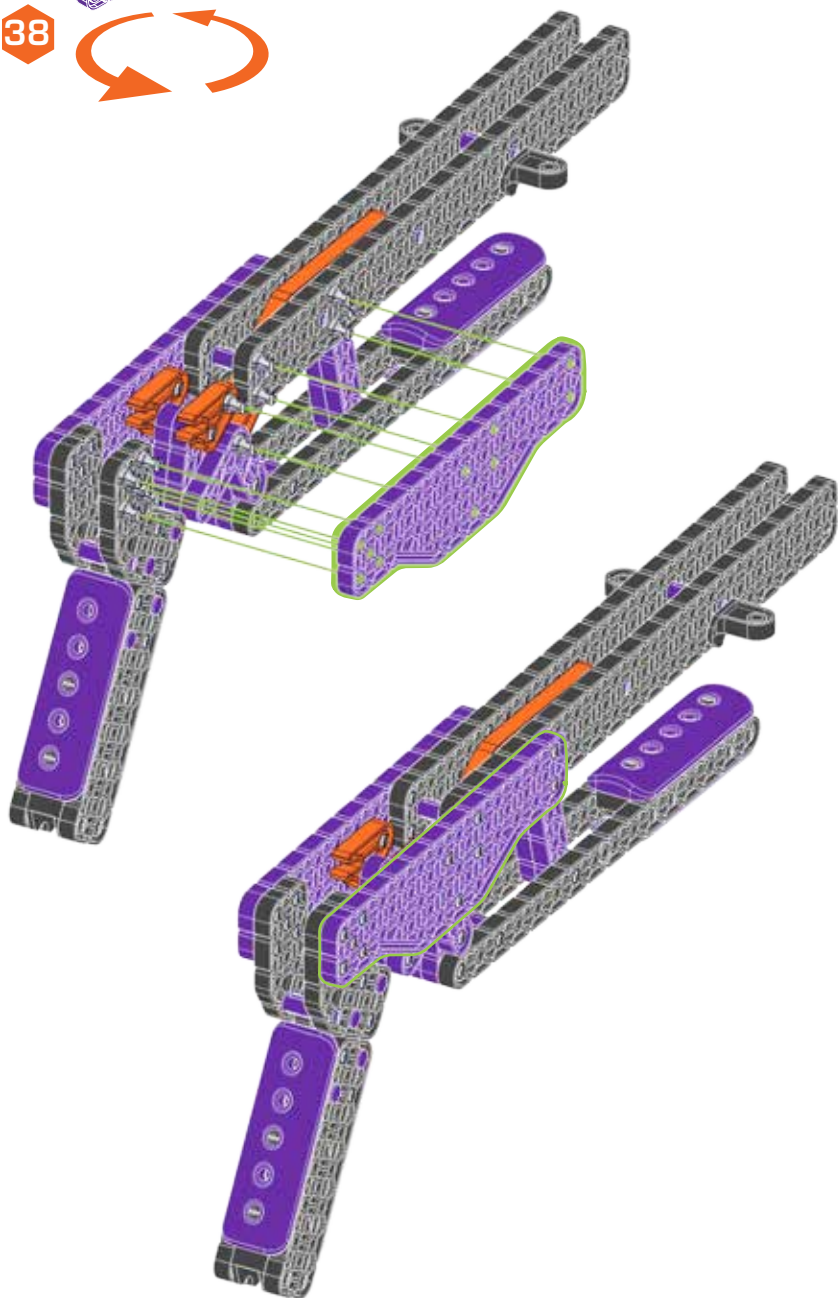



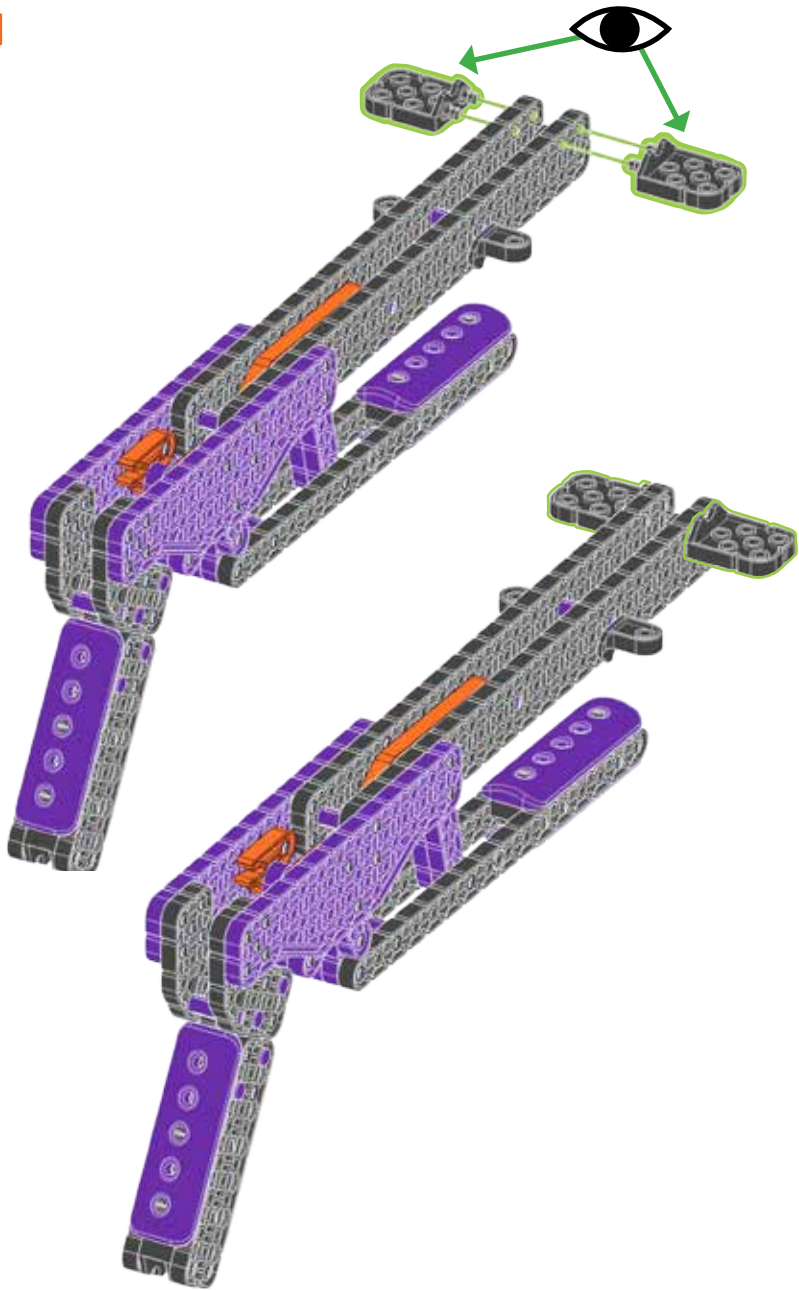

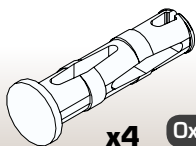

x4

0x3

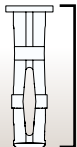

1:1

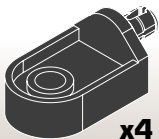

x4

1x20

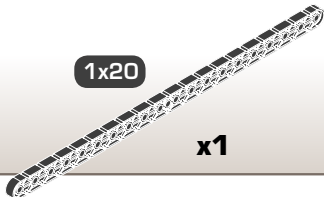

x1

40

4X

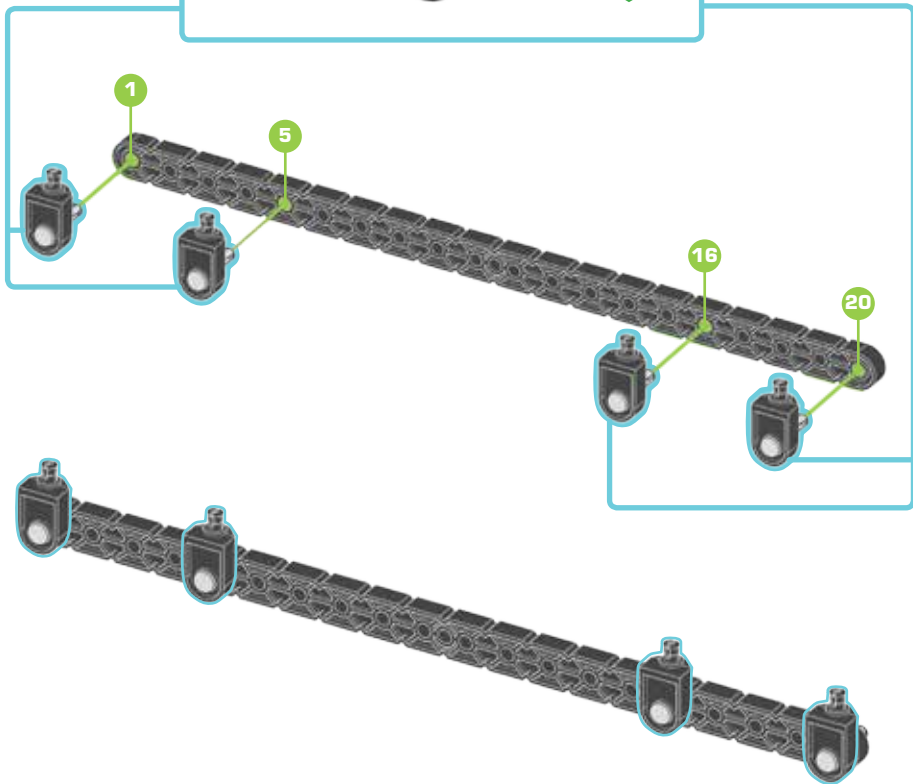
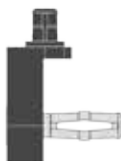

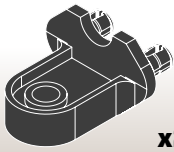

x2

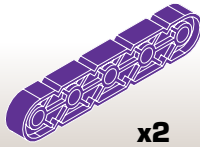

x2

41

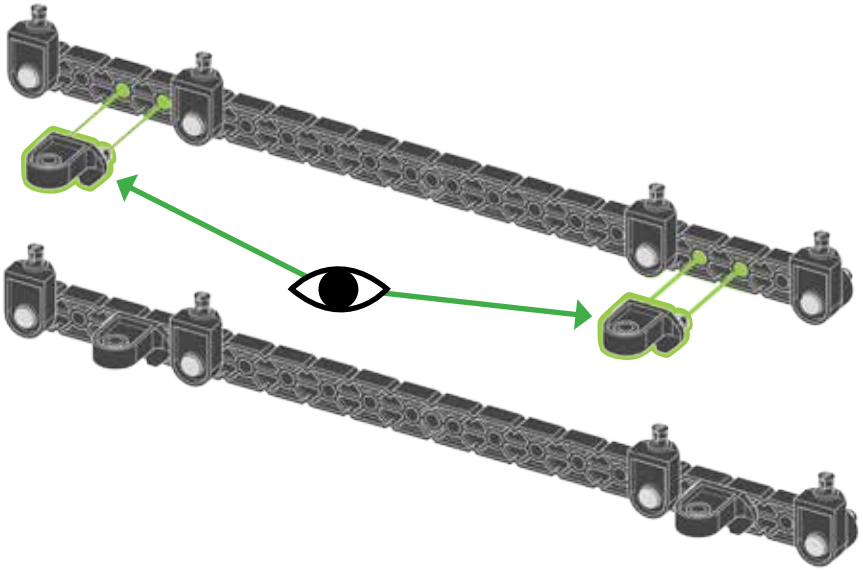

42

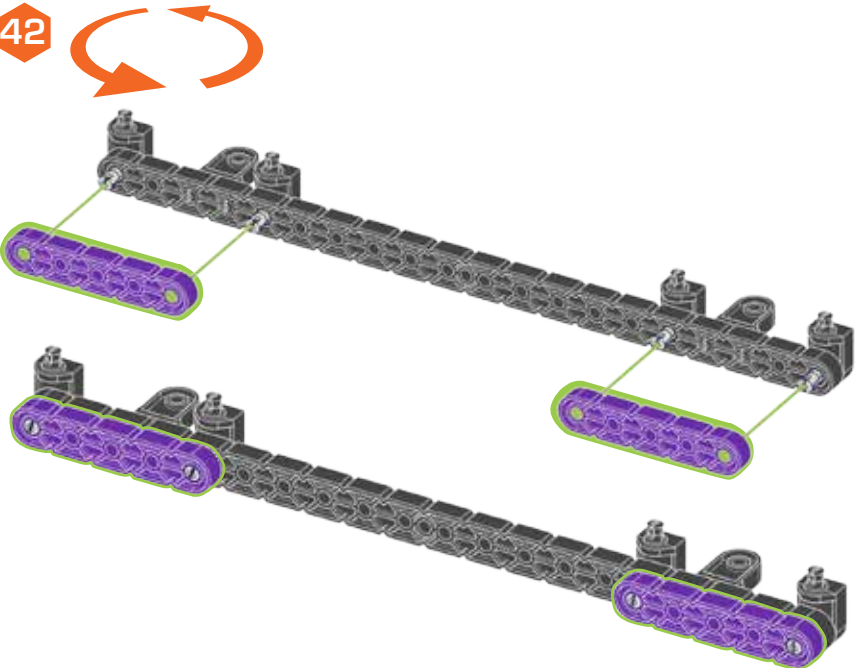

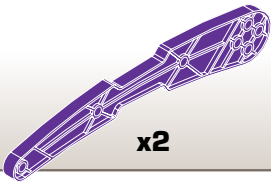

x2

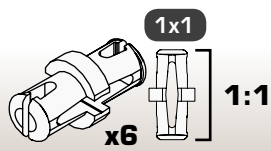

1x1

x6

1:1



x2

43

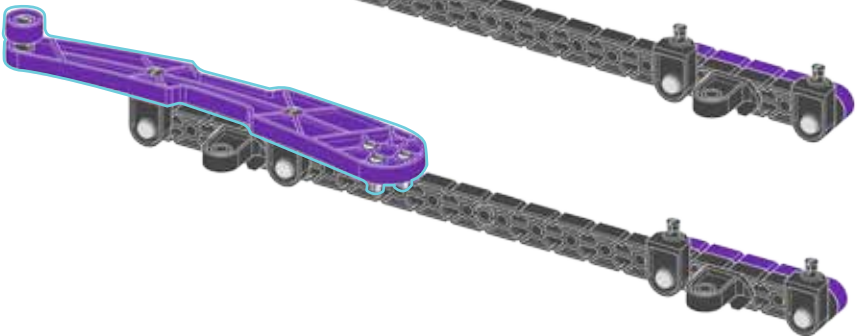
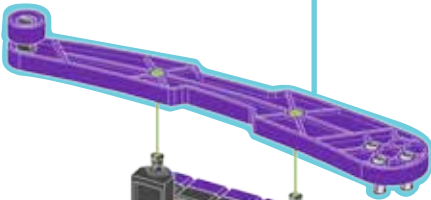
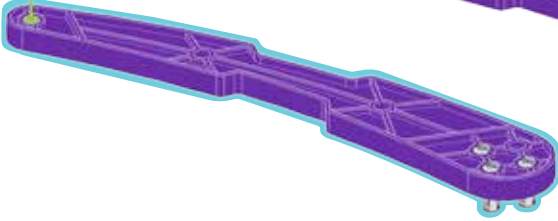
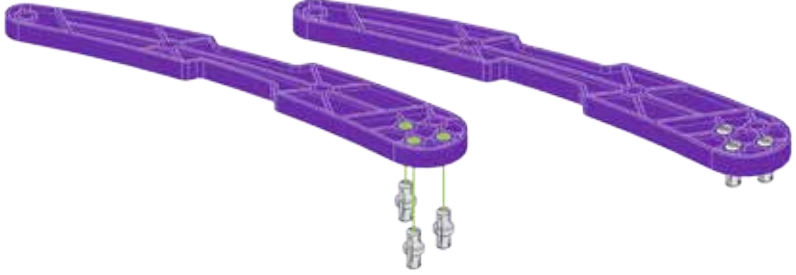

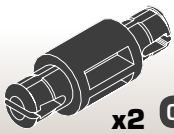

x2

0.5x



1:1

44

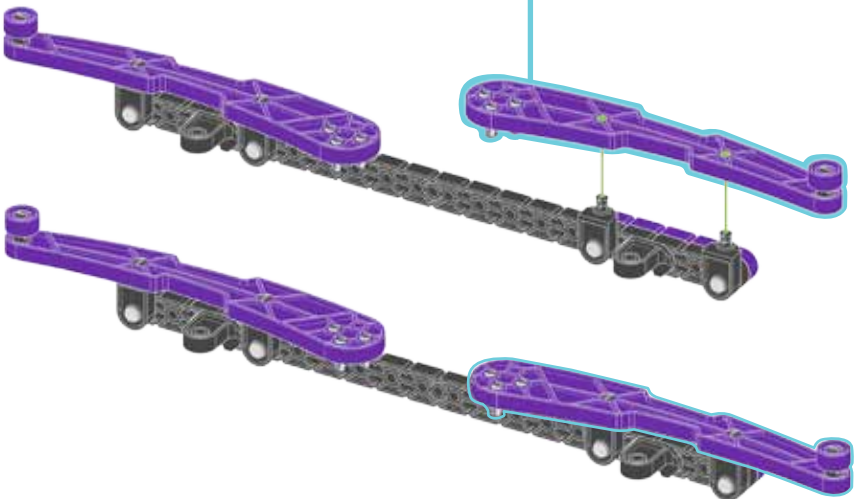
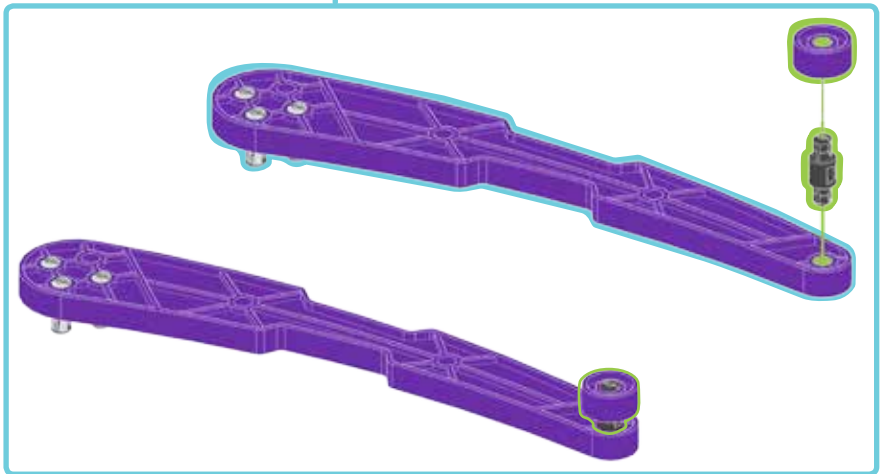
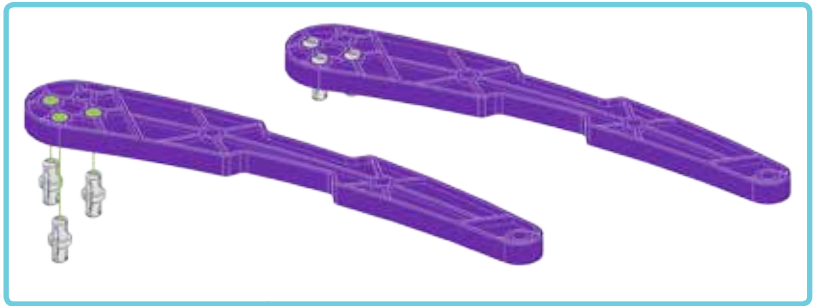

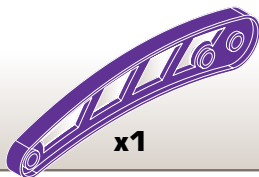

x1

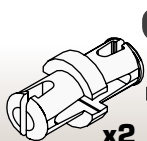

x2

1x1



1:1

45

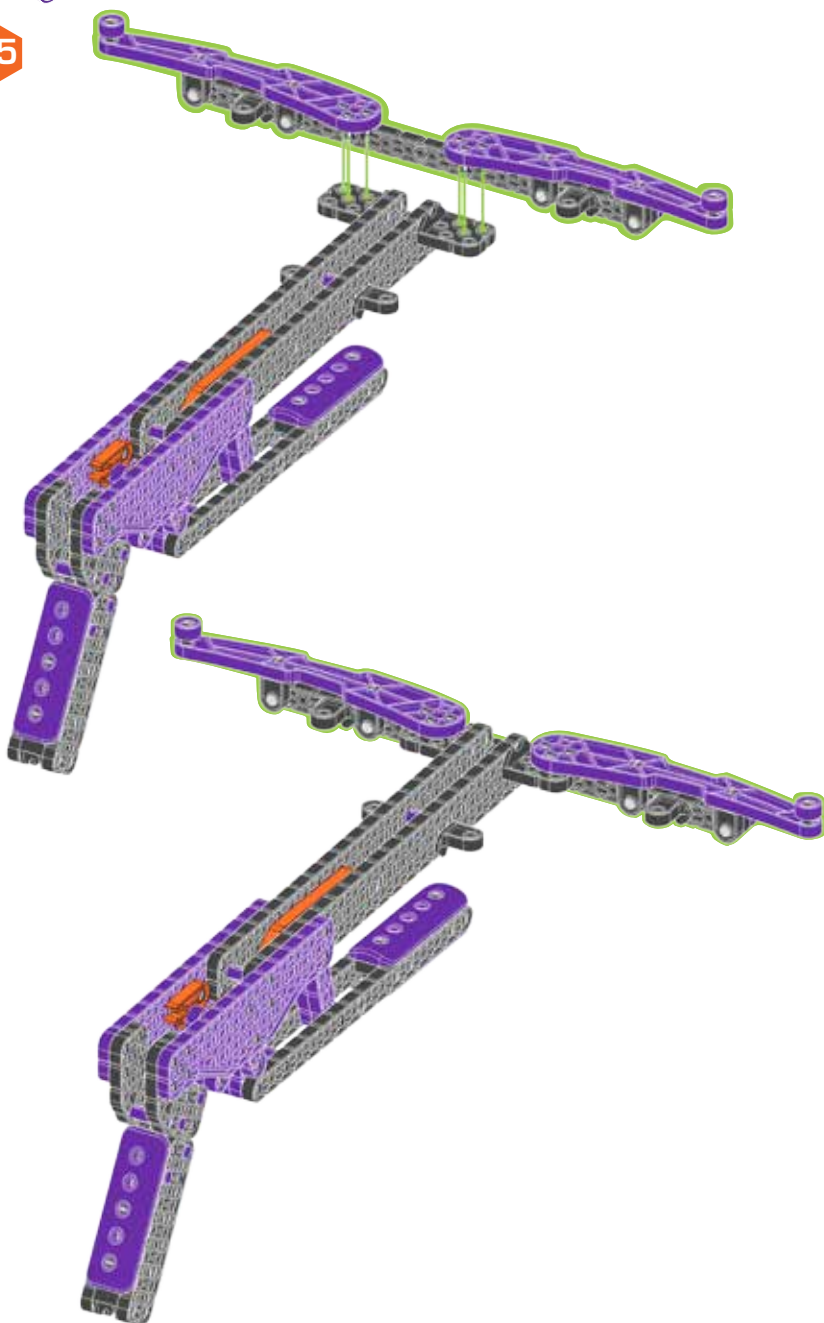

46

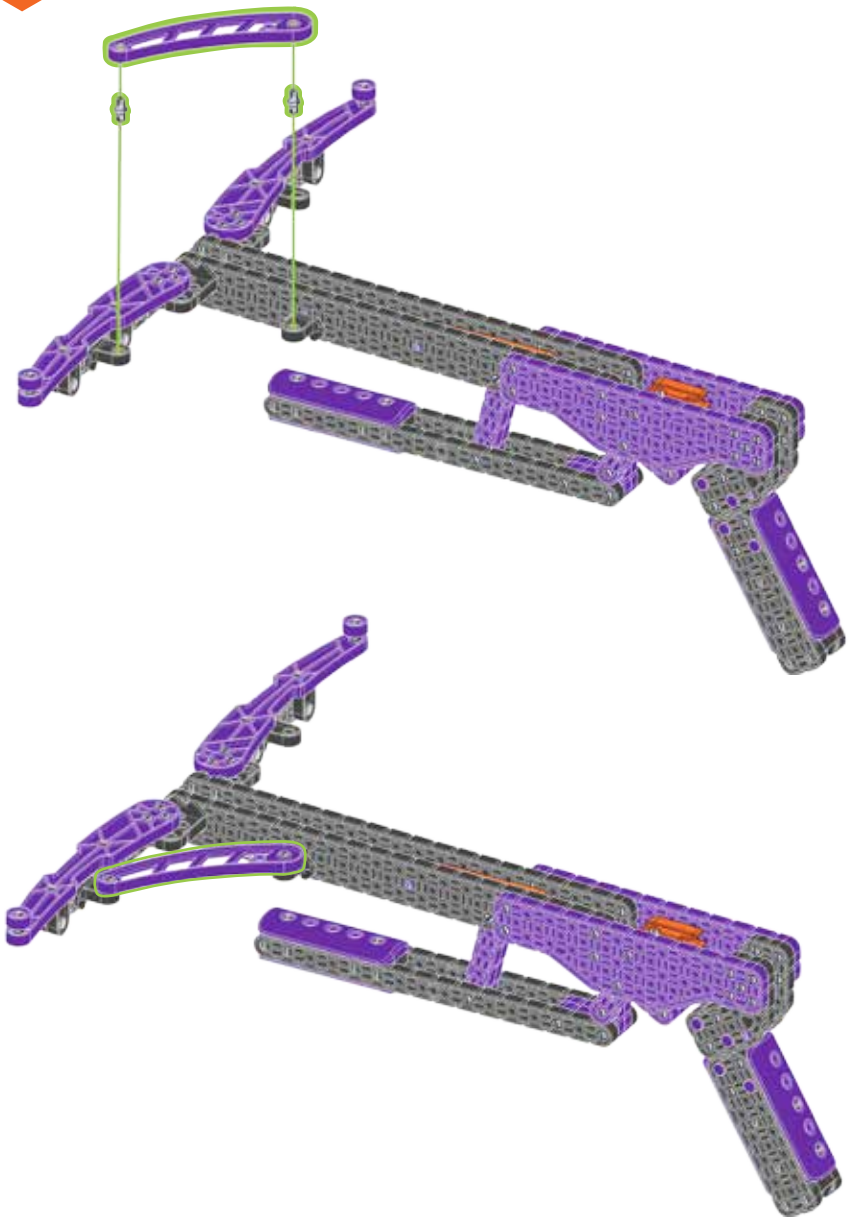

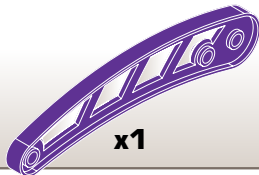

x1

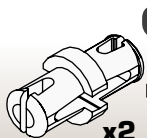

x2

1x1



1:1

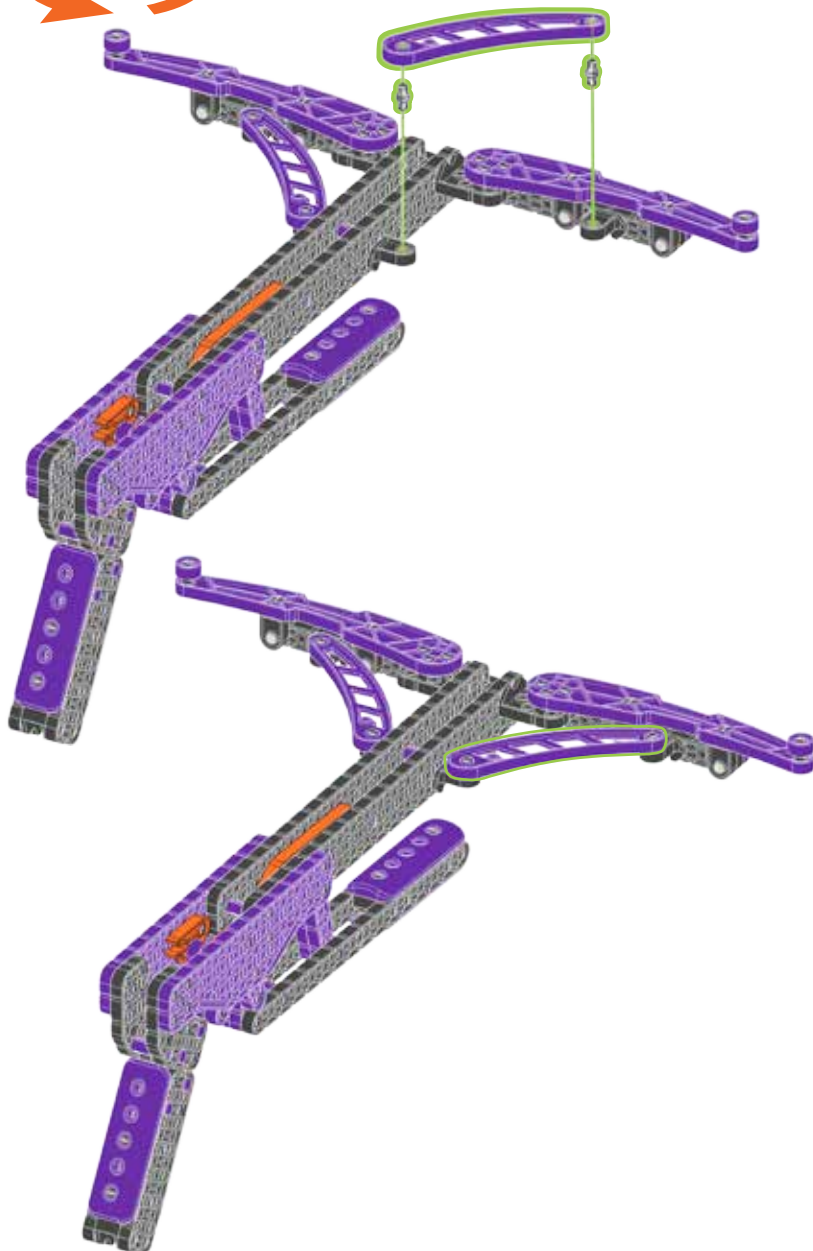



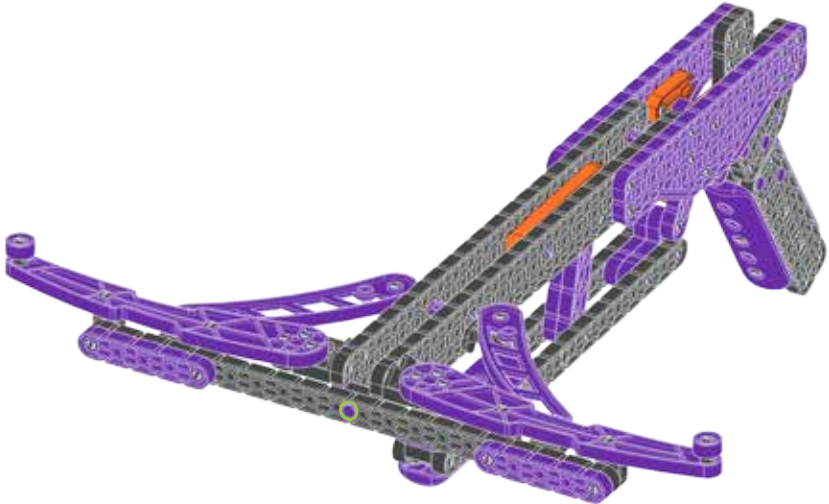
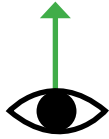
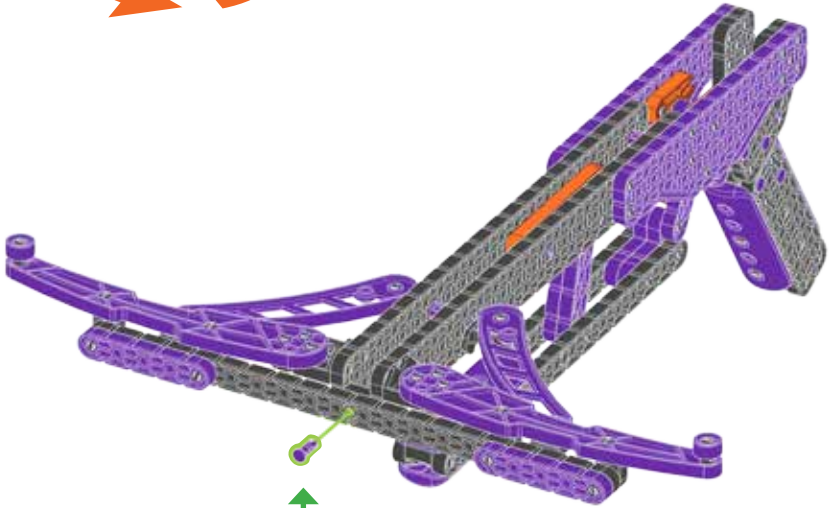

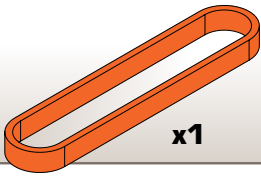

x1

49

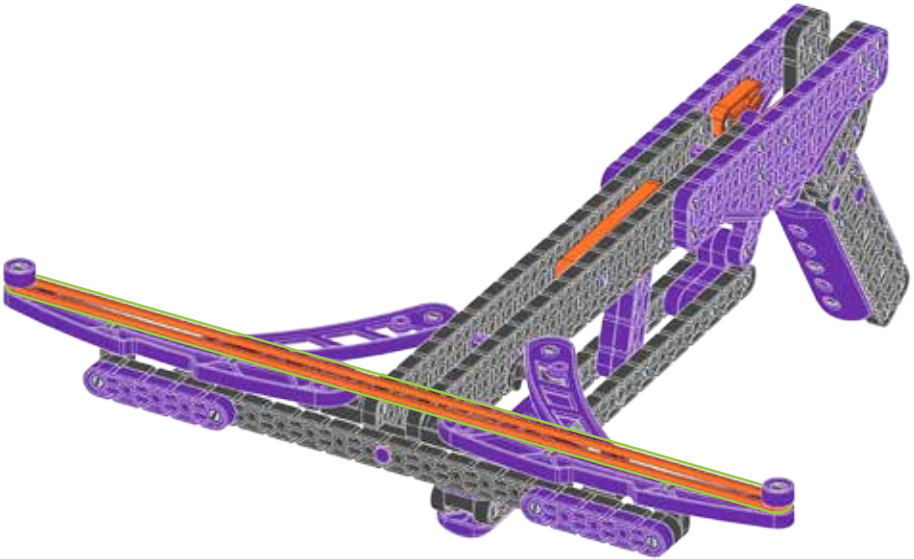
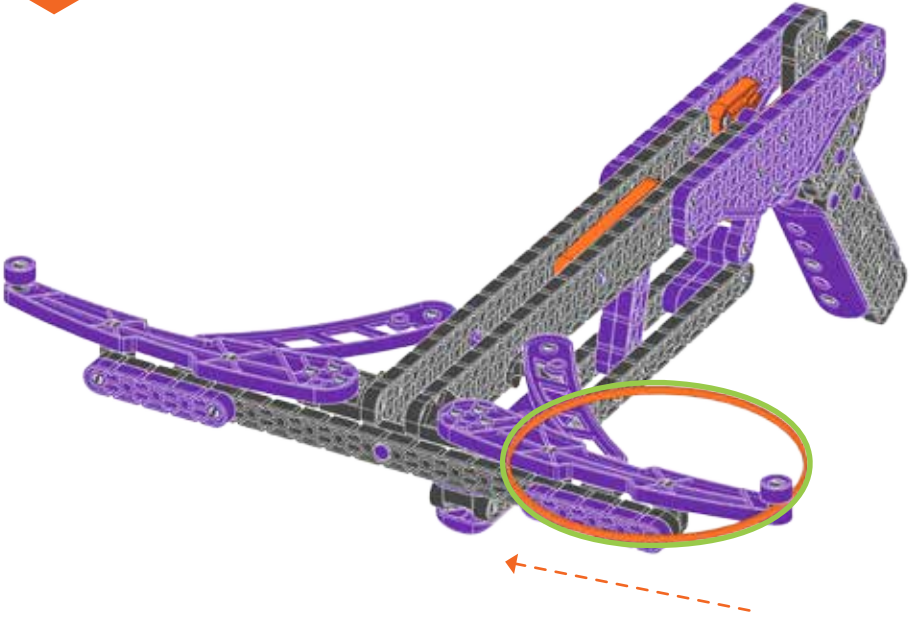

50

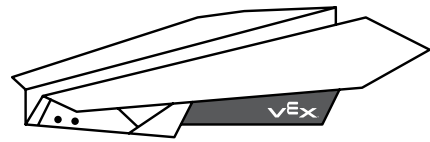
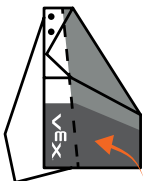
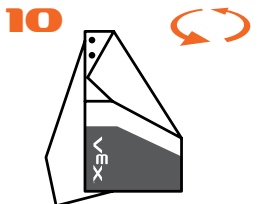
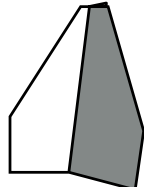
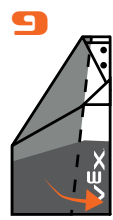
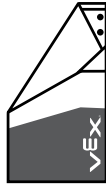
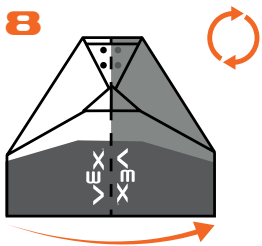
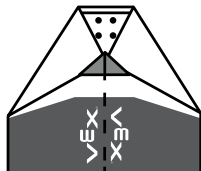
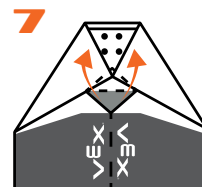
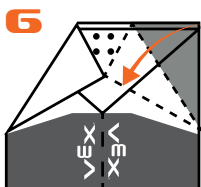
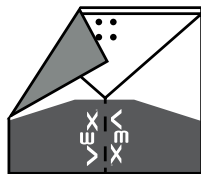
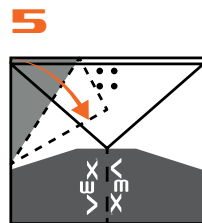
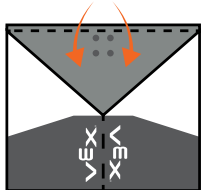
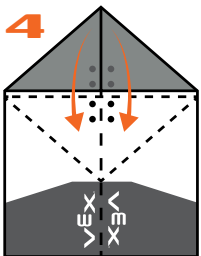
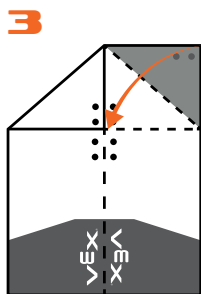
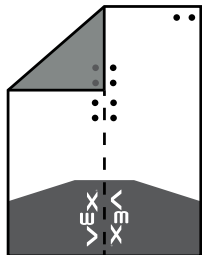
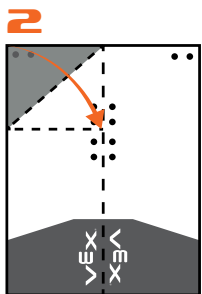
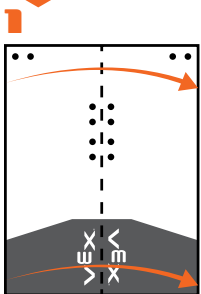

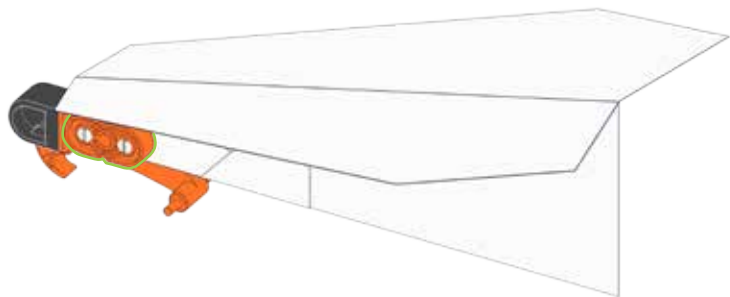
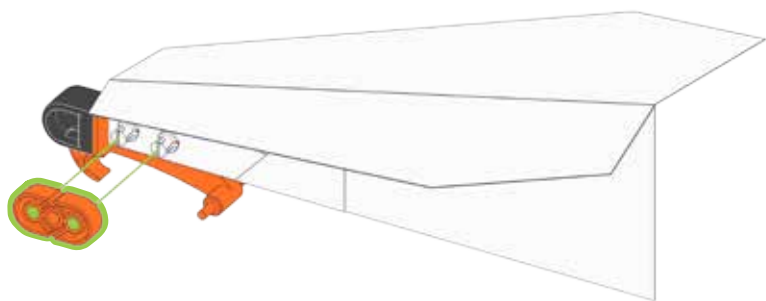
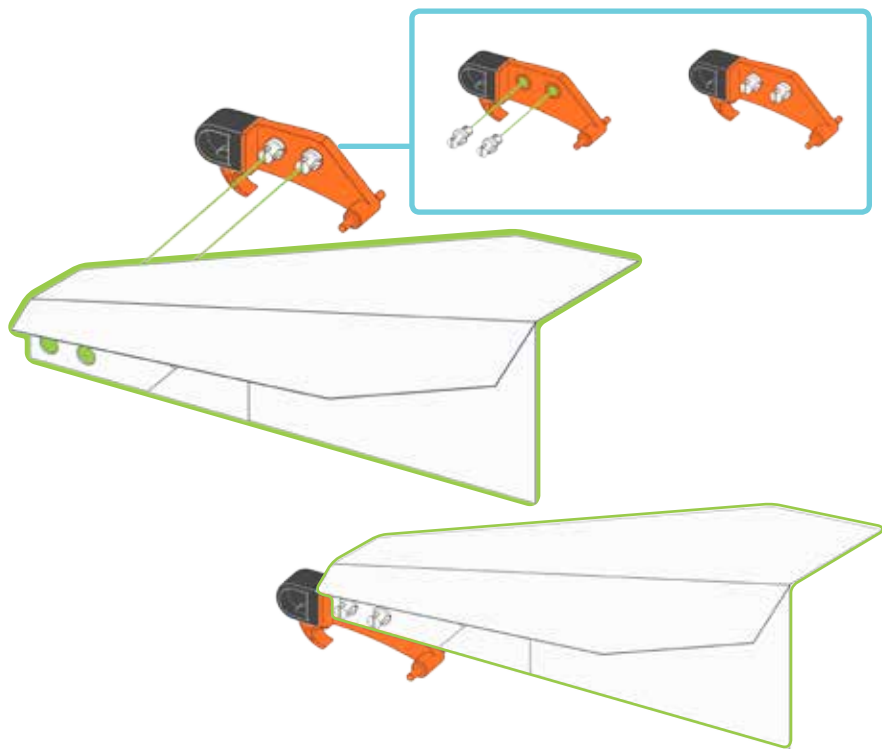

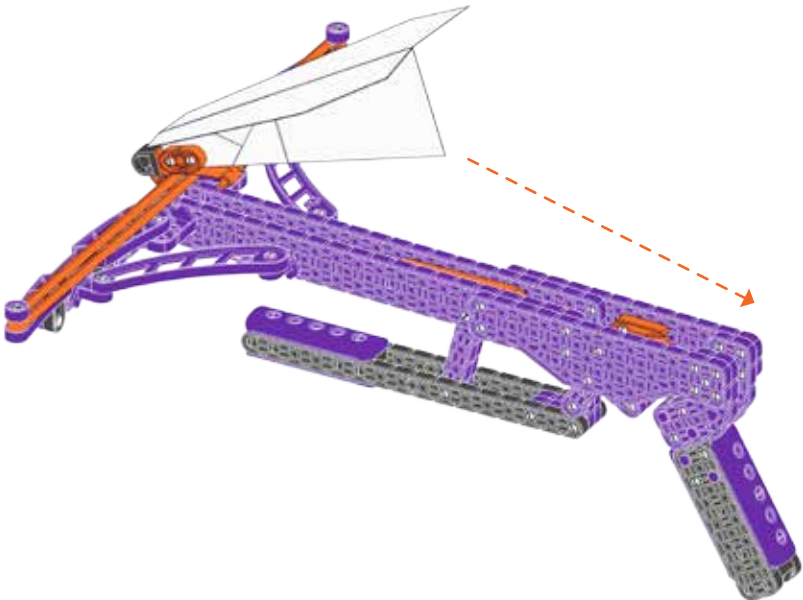
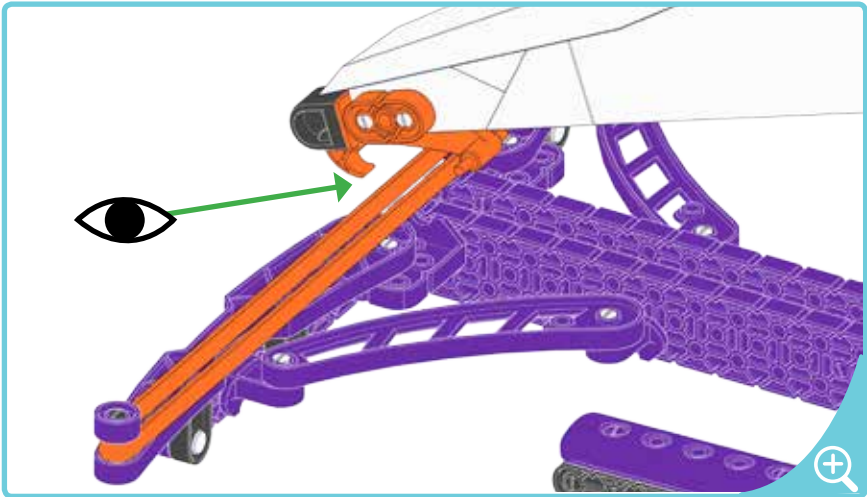
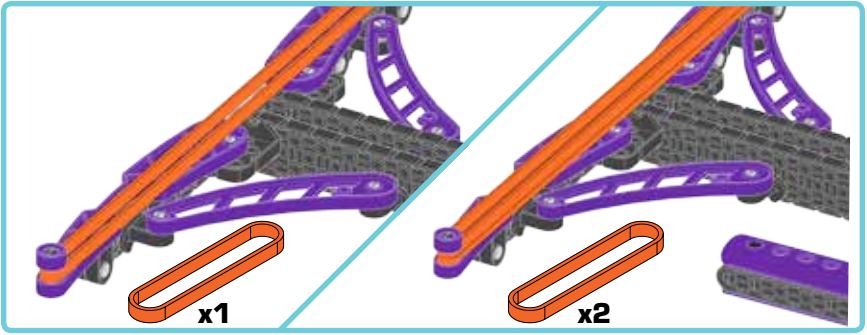

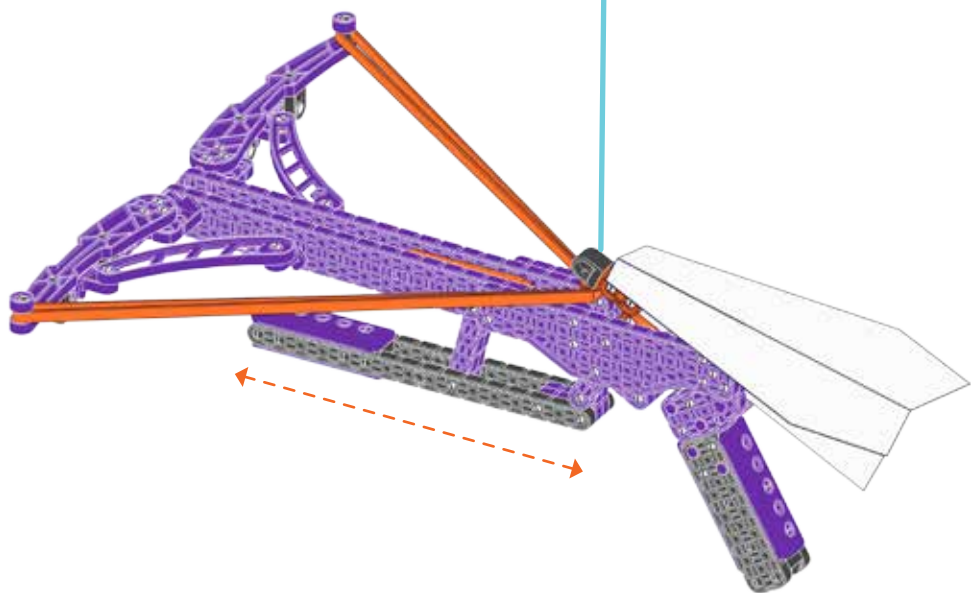
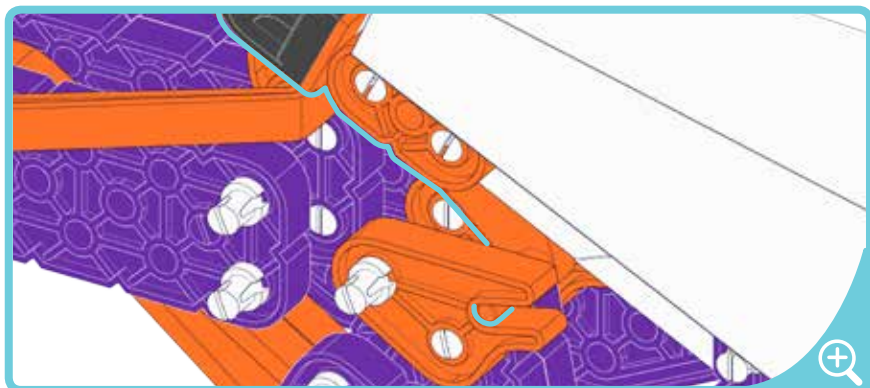

为确保儿童安全：

- 使用前，请去除所有包装和塑料袋等（如绳子和固定带等），并远离儿童放置，以防窒息危险。
- 定期检查玩具完好程度。如果出现任何明显破损部件，请停止使用，并远离儿童放置。
- 必须在成人监护下使用玩具。

产品的清洁与维护：

用拧干的柔软湿布清洁产品表面。不要使用洗涤剂或化学溶剂清洁玩具，防止损毁产品。

不使用产品时，勿将产品放置在高温、沙尘、潮湿处或水中。请勿自行维修或者改装产品。

赫宝®是创首国际的注册商标，图片仅供参考。  
请拆除所有包装后再给孩子们，并请保留包装备用。  
本产品符合安全要求。专利：创首国际  
中国制造与组装



使用前请仔细阅读说明书，并妥善保管。



赫宝官方微信



飞机弩

406-5516

LOT #

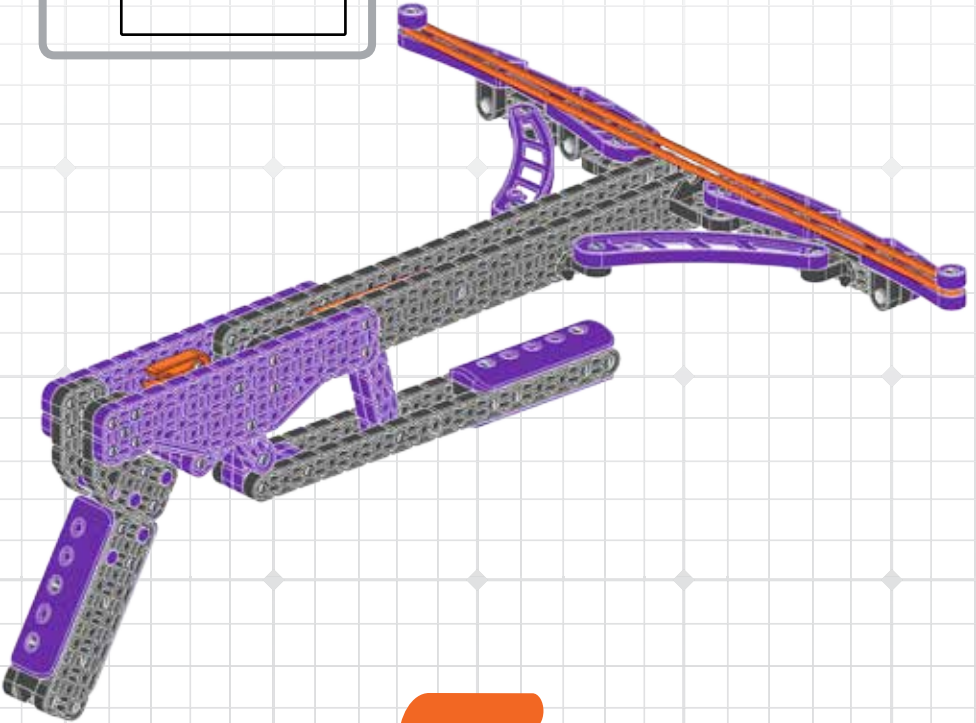

**VEX**<sup>®</sup>  
ROBOTICS

如需帮助，请登入：

[WWW.VEX.COM/HELP](http://WWW.VEX.COM/HELP)